

Your Payhauler is almost complete. Note the positions of the mud flaps and hoist pivot. Raise the dump body and slip the hoist pivot between the double walls as shown. Prepare two 233 pins by beveling their ends. Jiggle the pins into place and glue. Do both hoist units.

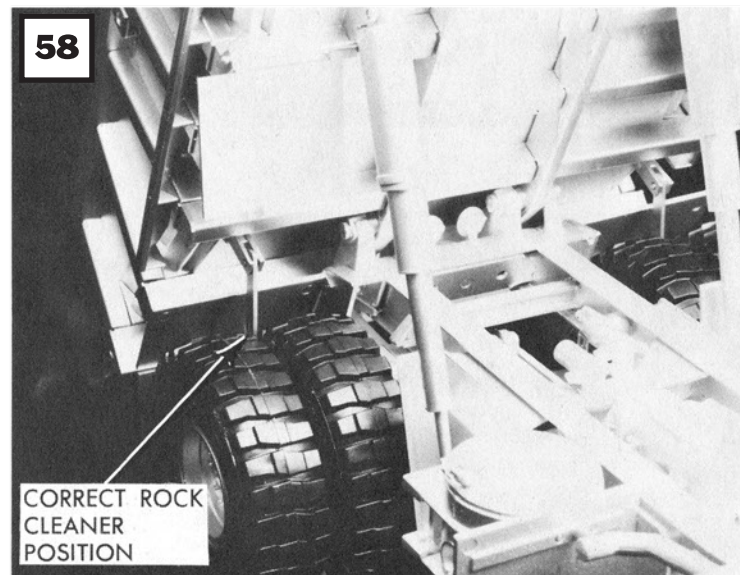

Apply the door decals as shown. If you are a good painter you can trim the weatherstrip bead around the windows in flat black. The windshield wiper is silver.

Your model is now complete. You can display it with dump body raised or lowered; hood on or off; cab door open or closed. It is a fantastic 1/25th scale model: certainly one of the finest kits ever done. Find other great AMT kits at your local hobby dealer or on-line.

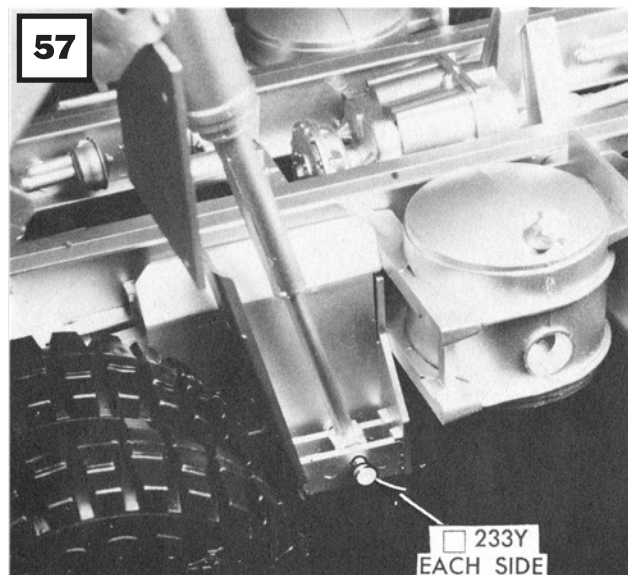
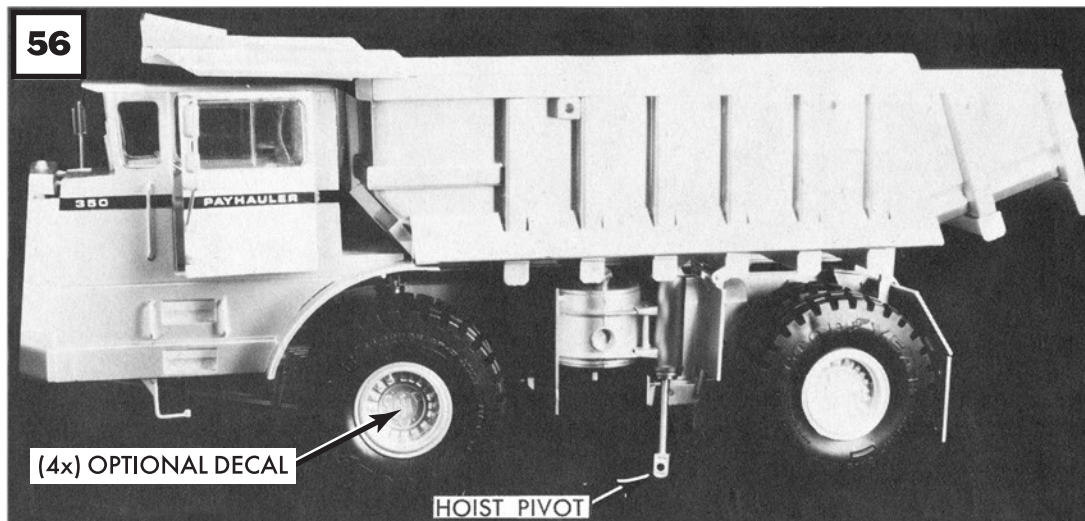

INTERNATIONAL®, and other International truck trademarks are licensed by INTERNATIONAL TRUCK INTELLECTUAL PROPERTY COMPANY. Goodyear (and winged foot design) and Blimp are trademarks of The Goodyear Tire & Rubber Company used under license by Round 2, LLC, South Bend, IN 46628. Copyright 2020 The Goodyear Tire & Rubber Company. AMT and design is a registered trademark of Round 2, LLC. ©2020 Round 2, LLC, South Bend, IN 46628 USA. Product and packaging designed in the USA. Made in China. All rights reserved.



INTERNATIONAL® PAYHAULER 350



1/25 Scale

This 1/25 scale International Harvester Payhauler 350 heavy duty construction (Off-highway) truck is considered by many to be one of the finest model kit vehicles to ever be produced. 428 precisely detailed parts come together to produce a model that is a classic in truck kit designs. The actual vehicle is huge—its tires stand about 68 inches high. The dump body can carry 50 tons of material. The engine is a supercharged 16 cylinder 2-cycle diesel and the crankcase carries 64 quarts of oil! Please study page 2 before beginning assembly, and work carefully—following the instructions, drawings and photographs. When you finish, you will own one of the most fantastic model kits ever produced.

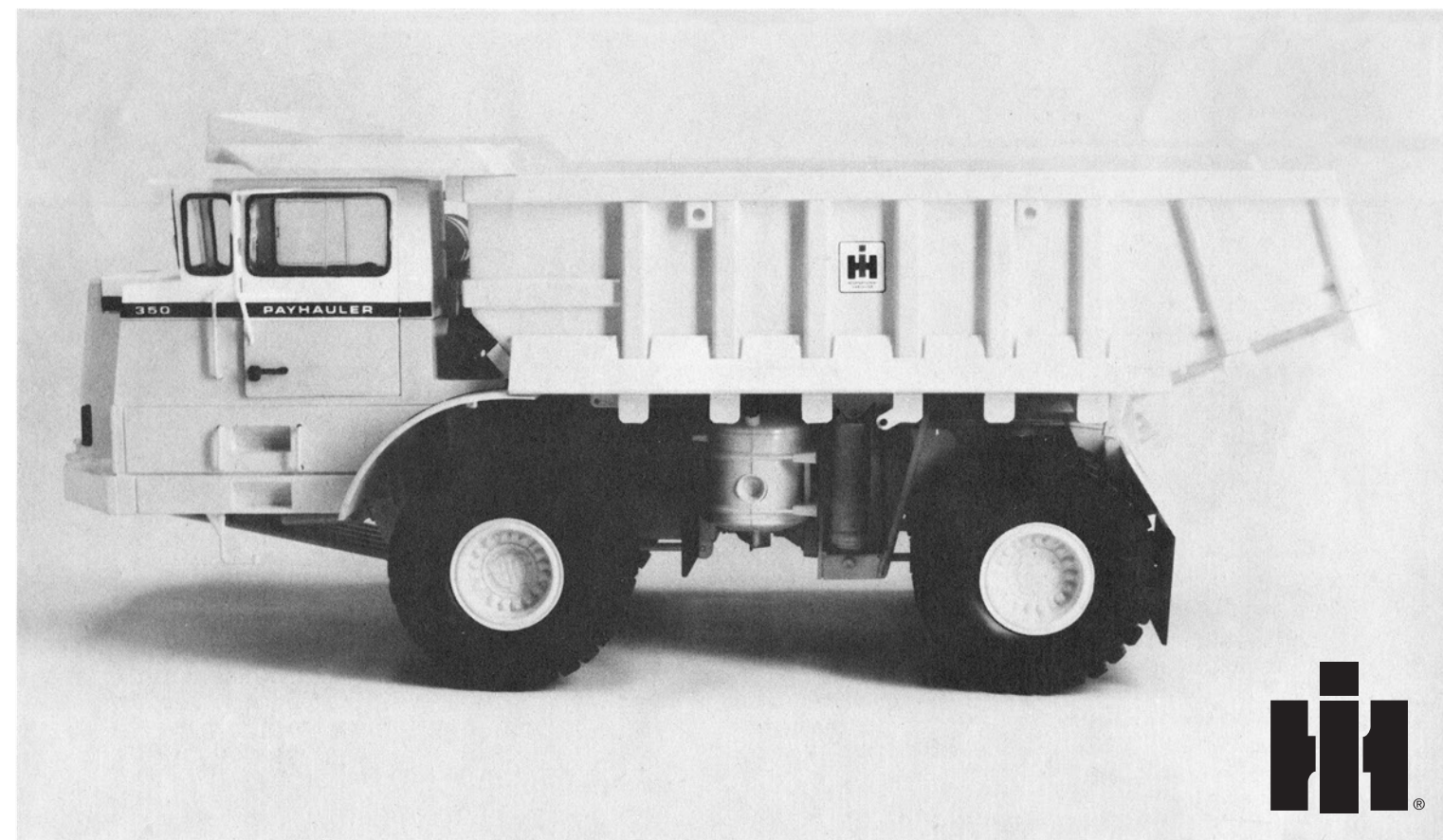

Please Read This Page Before Starting

Before you begin construction of this kit, spend time studying the parts and going over the assembly steps. PLEASE FOLLOW THE INSTRUCTIONS...they have been written to help you.

Tools such as files, model knives and fine sandpaper are recommended for use in making the build easier. Experienced builders may trim and file parts for a more precise fit.

Use cements and paints designed for styrene plastic. Your

model is designed to be assembled and displayed with a minimum of painting. However, painting instructions are provided in detailed steps.

Work slowly and carefully, allowing glue to dry between steps. Read through each step and study each part before assembly.

VERY IMPORTANT: Scrape paint away from surfaces before gluing parts together.

- ☐ 37BK . . . indicates *black* part
- ☐ 12W . . . indicates *white* part
- ☐ 5CL . . . indicates *clear* part
- ☐ 145Y . . . indicates *yellow* part

You are about to work with a checklist instruction sheet. As each part is applied take a pencil and put a check mark in the box in front of each number. In this way you can see what you have done and what you have not.

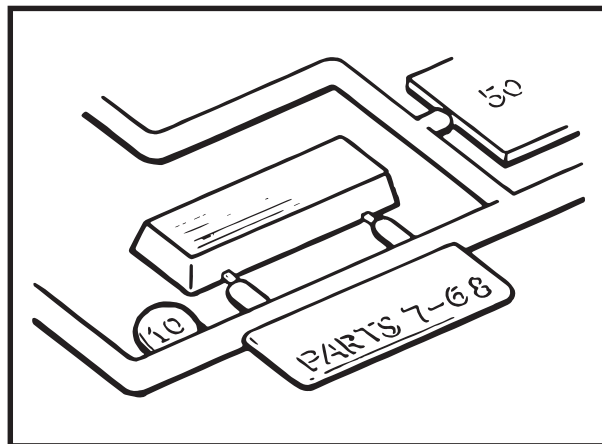

The parts are arranged in groups or trees and are numbered either on the part or an adjacent tab. An identification tab on the side of the tree indicates which parts, by number, are on the tree. Remove parts from trees only as you use them — not before.

MODELING TIPS

HOBBY KNIFE

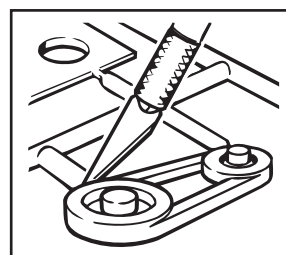

Use a sharp hobby knife to remove parts from the trees. Some parts may appear to have an extra "tab" on them, these should be removed.

TWEEZERS

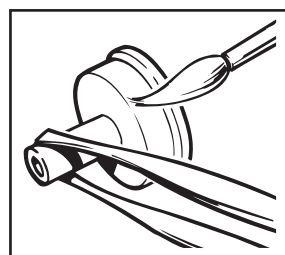

Tweezers are handy for holding very small parts during assembly or painting.

CEMENT

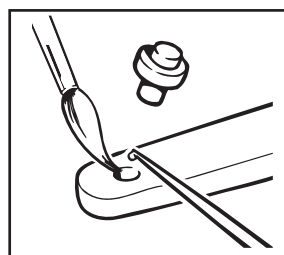

We recommend the use of liquid polystyrene cement. Apply with a fine brush or toothpick. Use cement sparingly or a sloppy job will result.

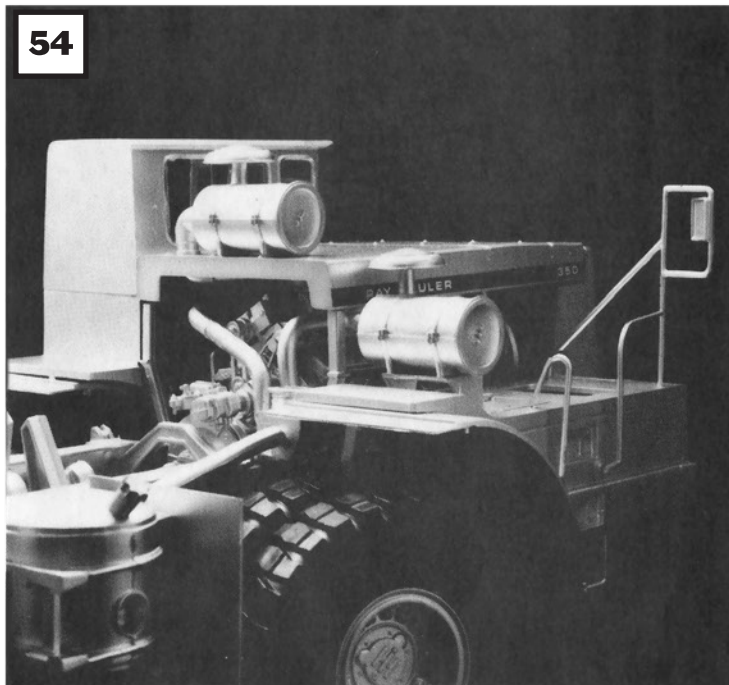
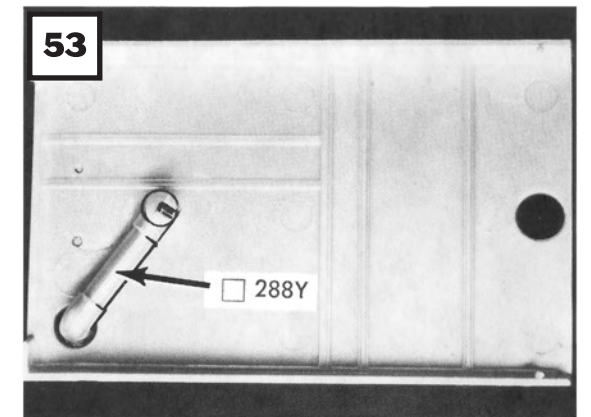
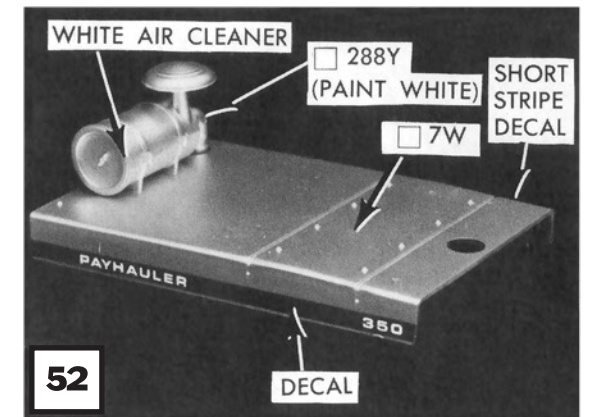
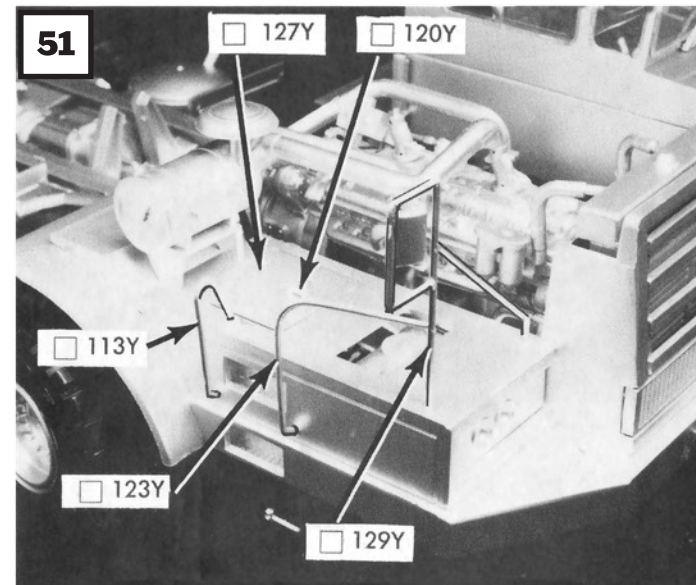

UPPER LEFT

Glue batter box door handle to battery box door. Glue the mirror and handholds into place.

UPPER AND LOWER RIGHT

Glue the white air cleaner into place on the hood. Apply decals as shown. Slip air cleaner pipe—288—through hole in hood and into hole in end of air cleaner. Glue as shown and paint white.

LOWER LEFT

Place hood in place as shown—either glue or simply rest in position.

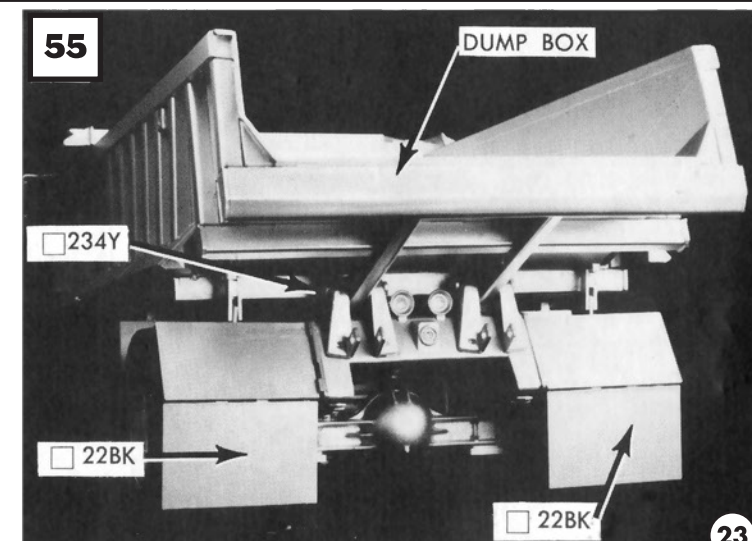

Prepare two 234 pins by beveling their edge as done on the two pins already in place. Slide the two pins in place out of their holes until they strike the backup lamps. CAREFULLY set the dump box down between the pivot arms. Be sure your hoist cylinders and mud flaps are not jamming against the frame. Jiggle the pins into place in the dump box frame pivot holes. Add the other pins—jiggle into place and glue all heads to the pivot arms. Glue the mud flaps—22—into place.

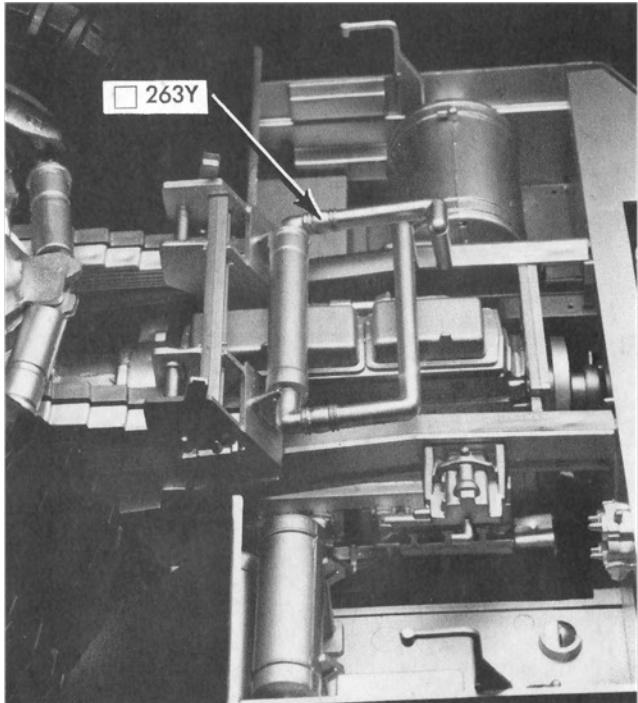
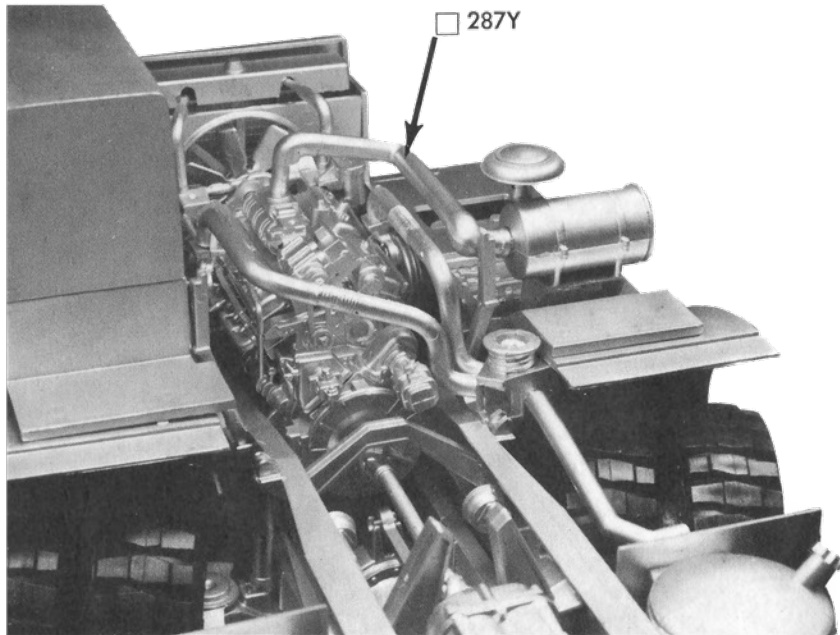

ENGINE

Glue parts 193Y & 194Y together. Now add 211, 212 & 213. Assemble forward supercharger 206, 207, 214 & 216 exactly as shown, then glue to engine block (193 & 194). Now assemble rear supercharger exactly as shown, then glue to block. Assemble the remaining parts exactly as shown.

FIT PARTS TOGETHER BEFORE CEMENTING. CUT FILE AND FIT AS NEEDED.

SEE PHOTOS ON PAGE 4.

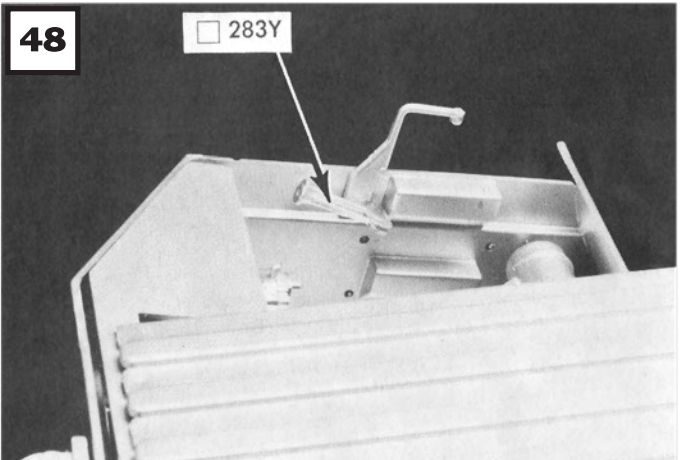
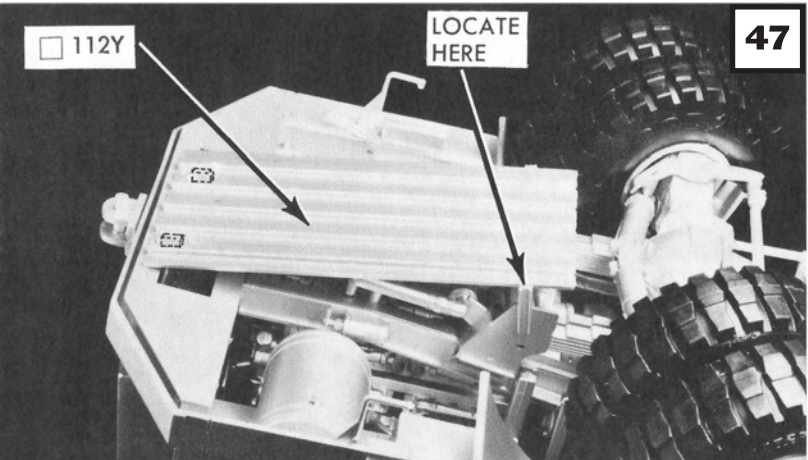
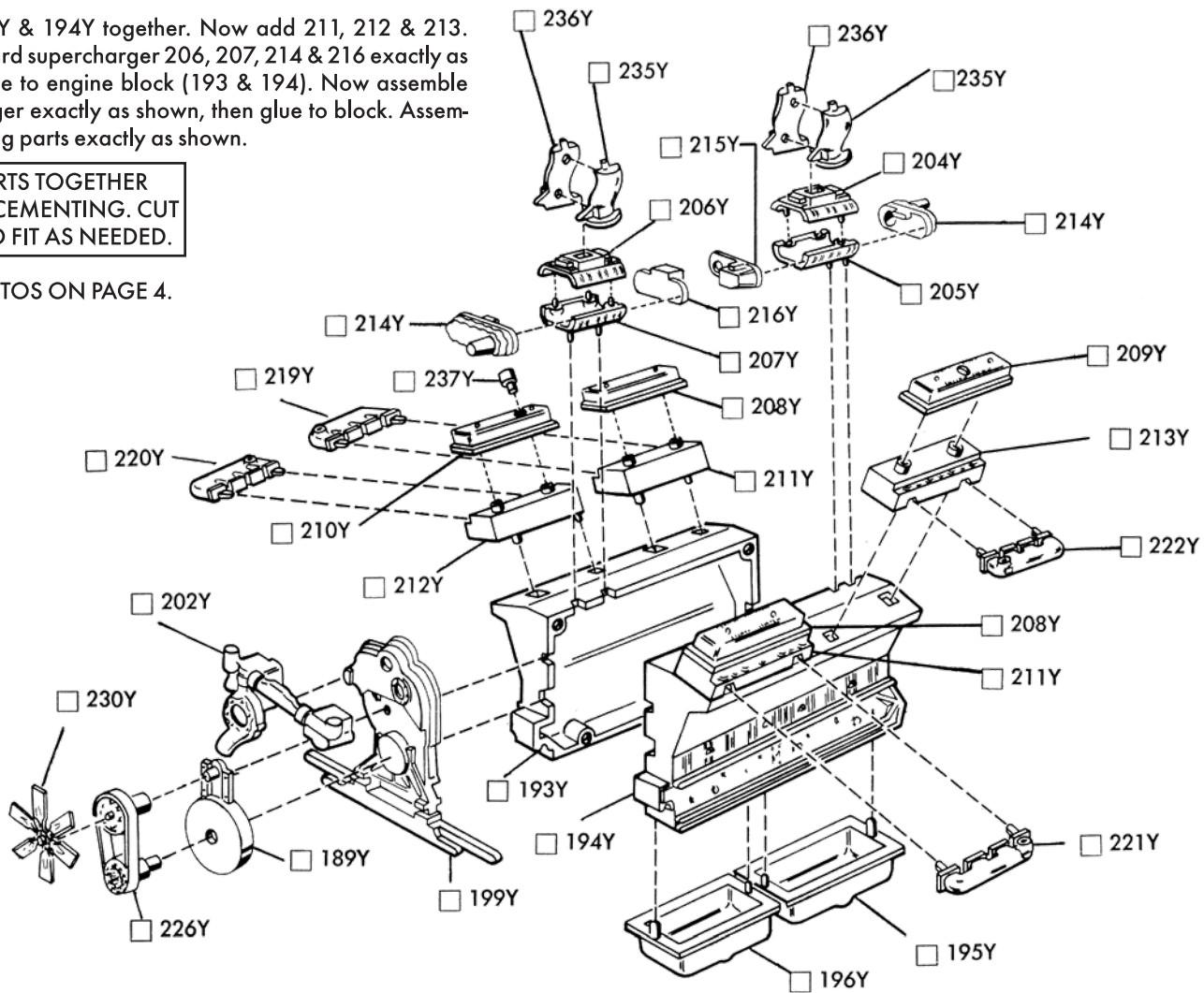

SEE PHOTOS ON PAGE 4.

Glue parts into place exactly as shown. See note for parts 201Y. Check photos on page 4.

PEG ON PARTS 201Y CAN BE TRIMMED AWAY FOR EASIER FITTING.

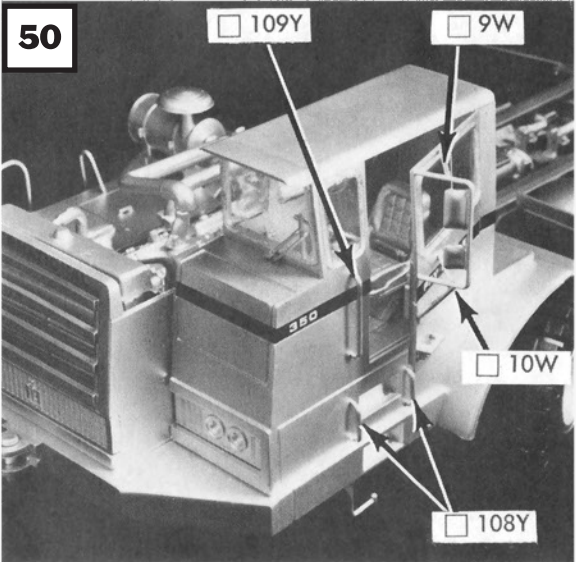
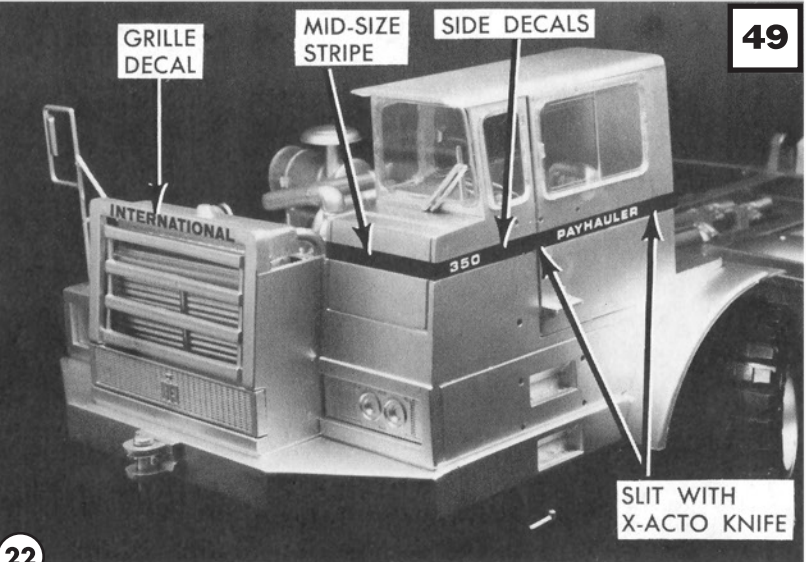
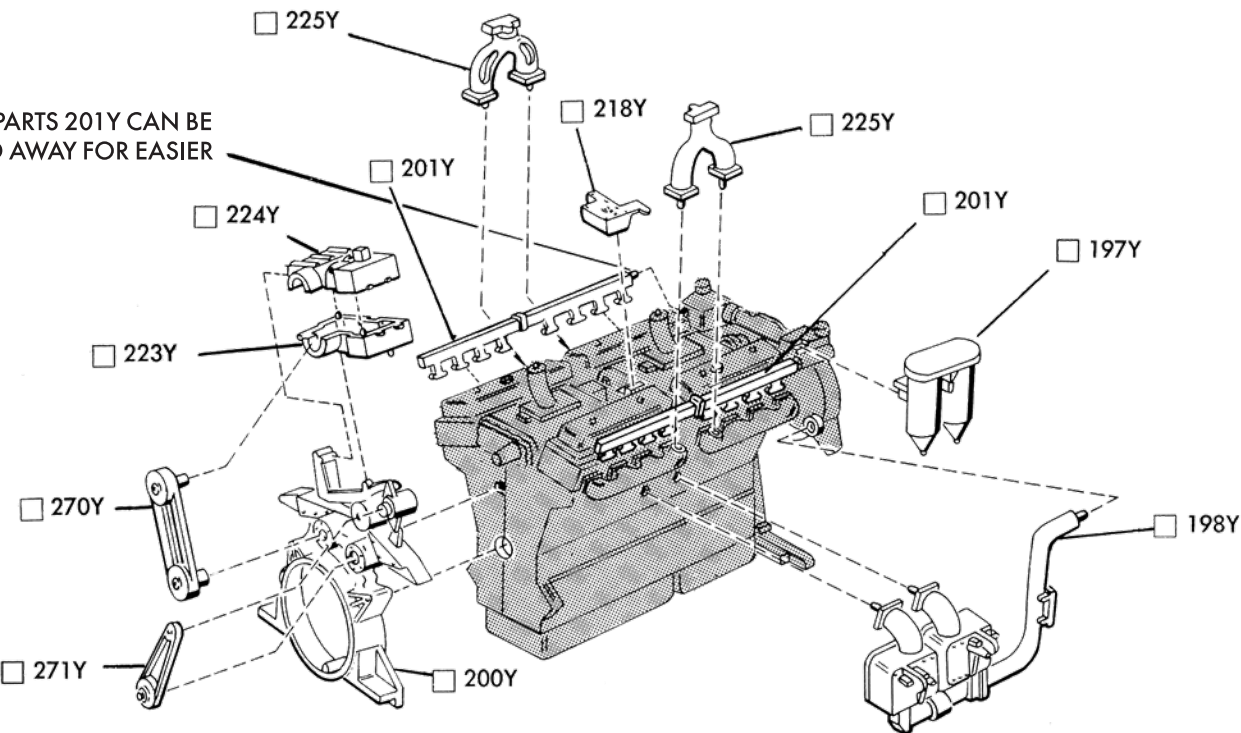

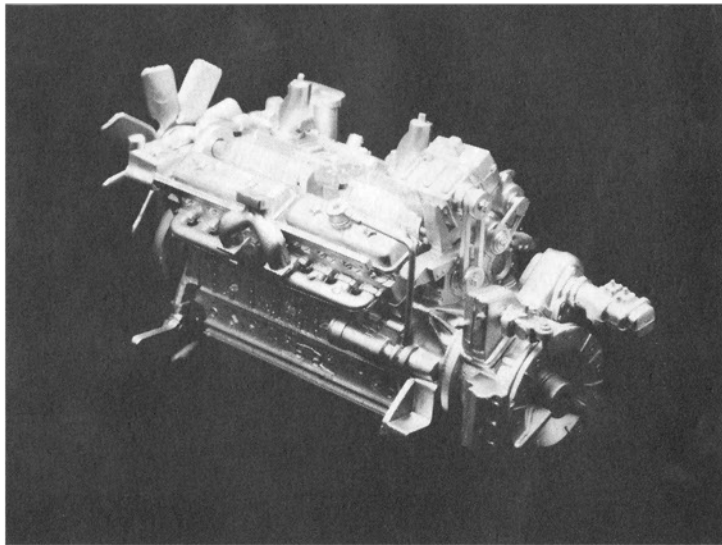
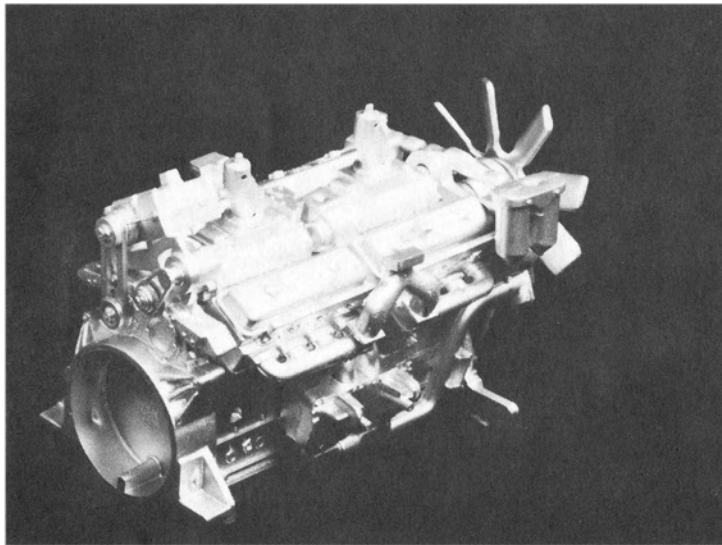
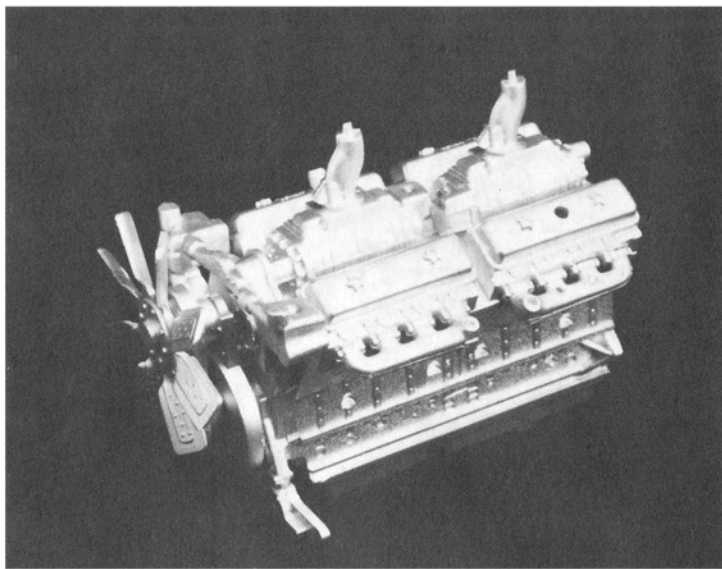
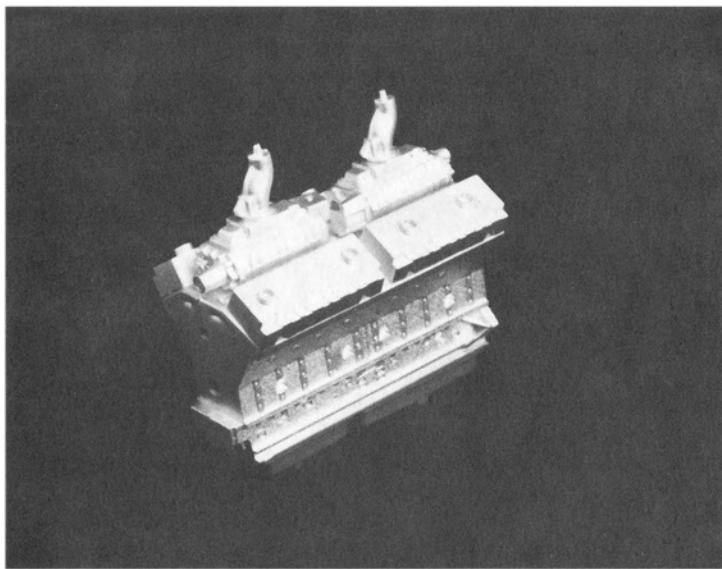

Due to the weight of your model we recommend the front wheels not be allowed to rotate—the model could roll off a shelf, and have designed an interference fit on the front steering knuckles. If you insist the wheels rotate, you must cut away material on two hubs as shown below, then use them on the front axle. Place a drop of oil on all axle ends and press hubs into place. Glue 188 and 281 into place.

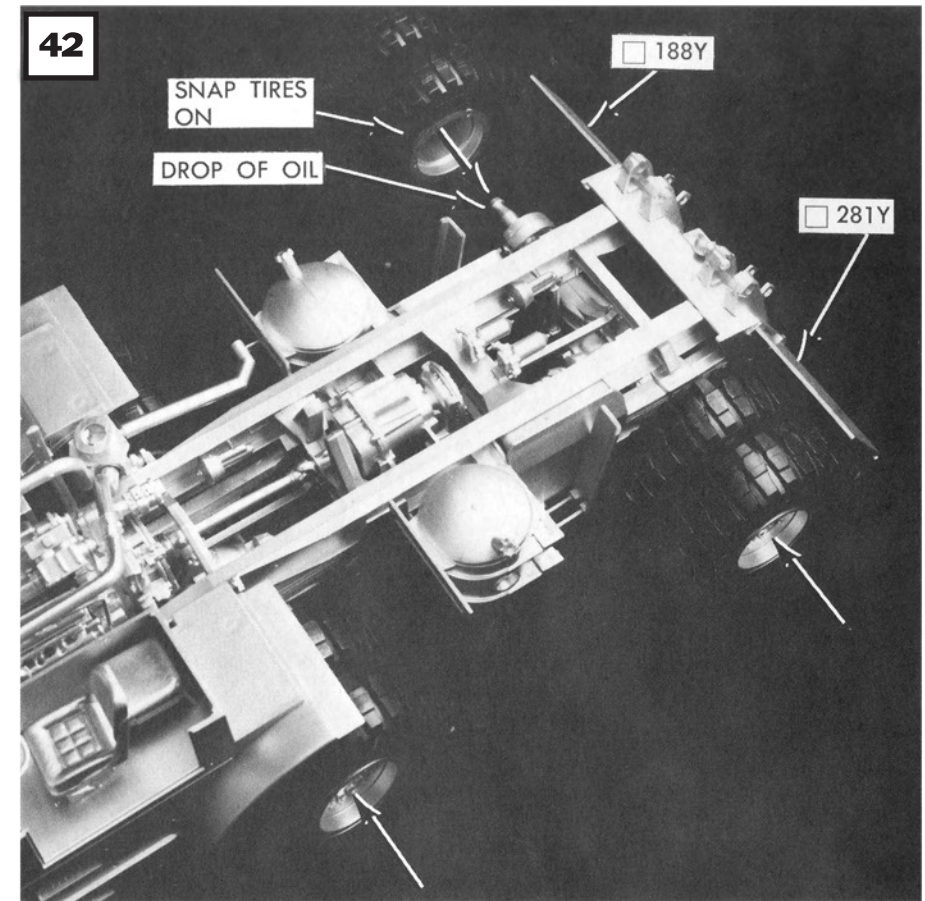
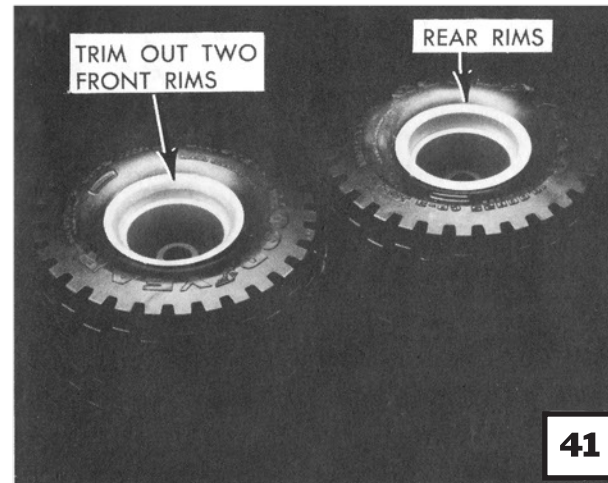

BELOW AND RIGHT
With the cab door upper hinge pivot pin trapped by the hinge socket in the upper cab, lower the upper cab and door down to the glued edge of the lower cab. Guide the lower hinge pin into the hole in the cab floor.

Glue the batteries into the battery box. Glue 177 into place exactly as shown. Now glue the assembled yellow air cleaner into place. Glue air cleaner hose—287—into place as shown.

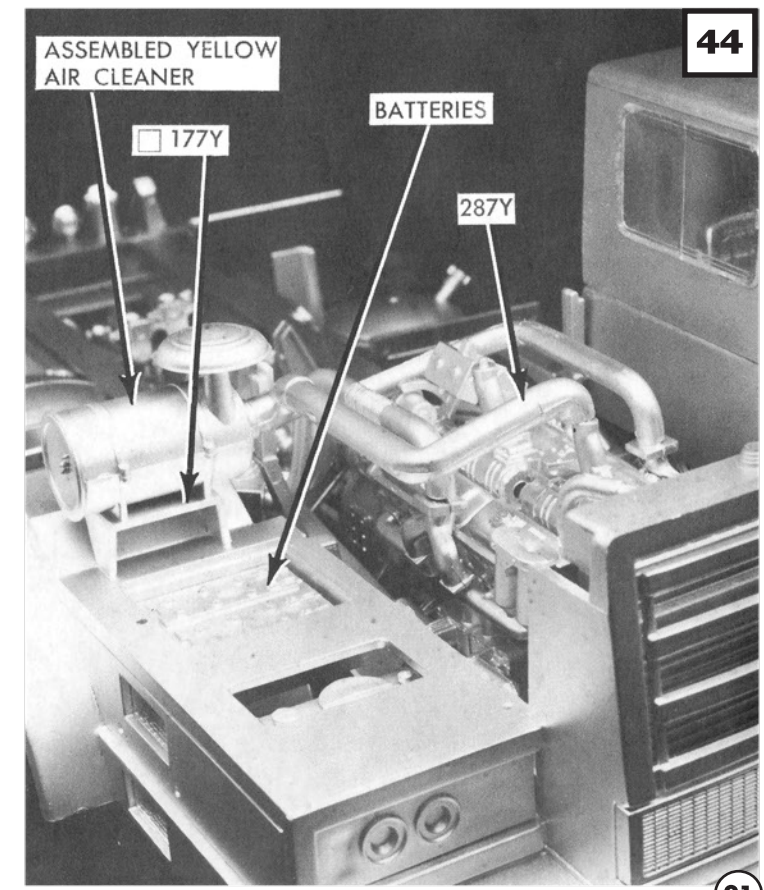
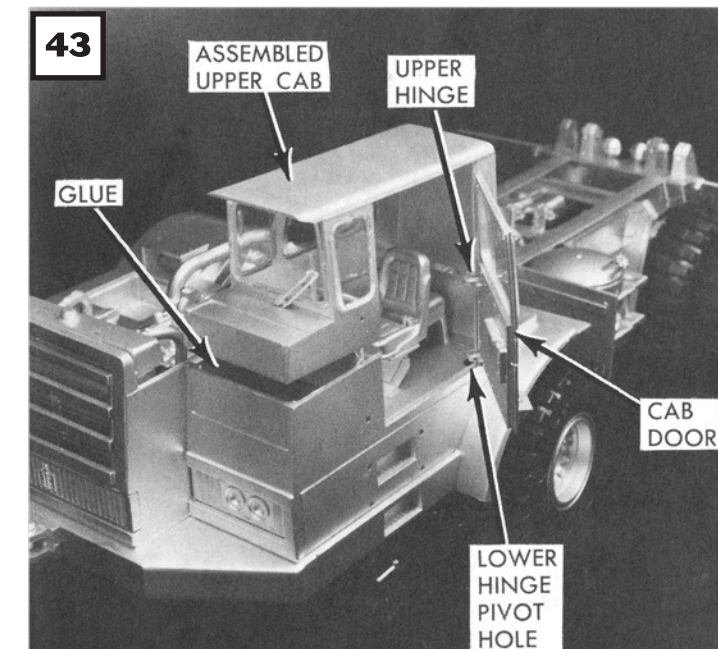
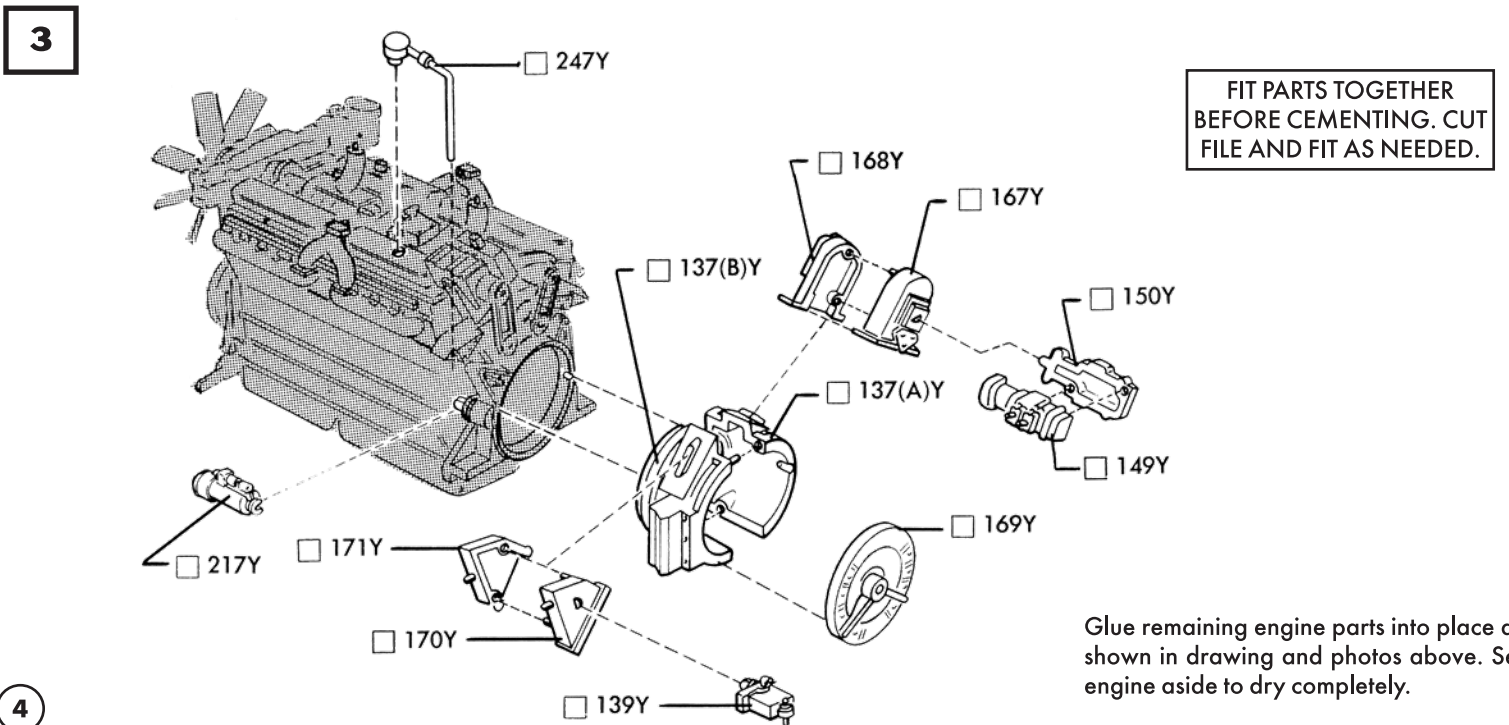

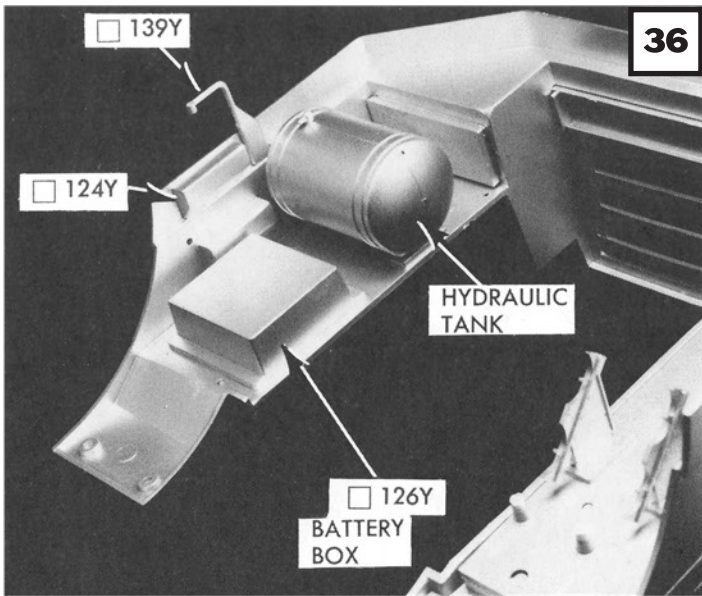

CAB PHOTOS

UPPER PHOTOS
Glue in step boxes—124—and hanging step—139. Glue hydraulic tank and battery box into place.

CENTER PHOTO
From above chassis, slide cab down and glue to bumper pieces and outrigger arms as shown. **IMPORTANT TIP:** Clip one clothes pin on each end of the bumper to hold the cab down while the glue dries. Glue the air tanks in place.

BOTTOM PHOTOS
Glue the fenders—117 & 118—into place.

FIT PARTS TOGETHER
BEFORE CEMENTING. CUT
FILE AND FIT AS NEEDED.

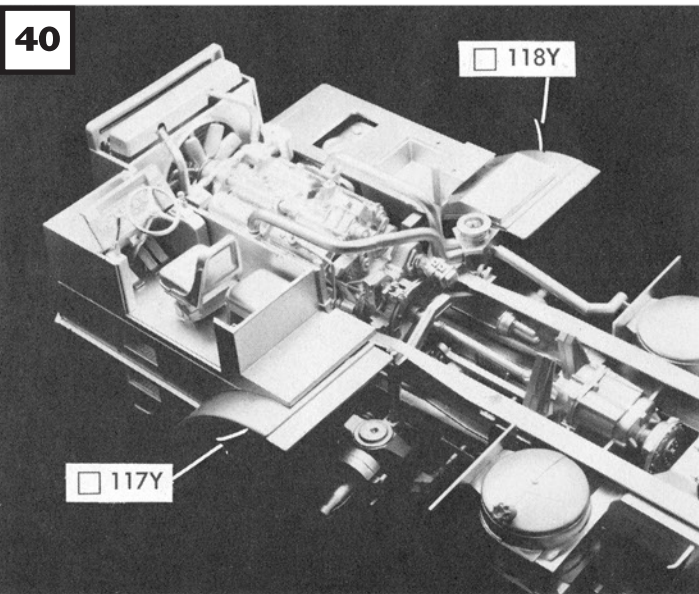
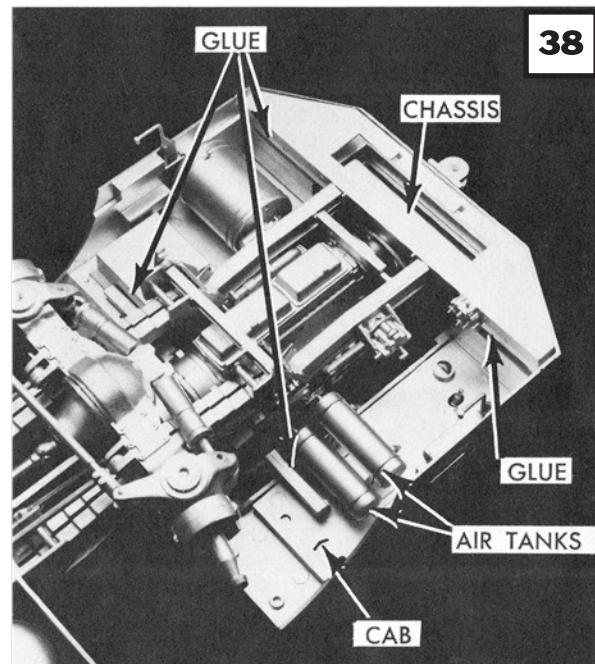
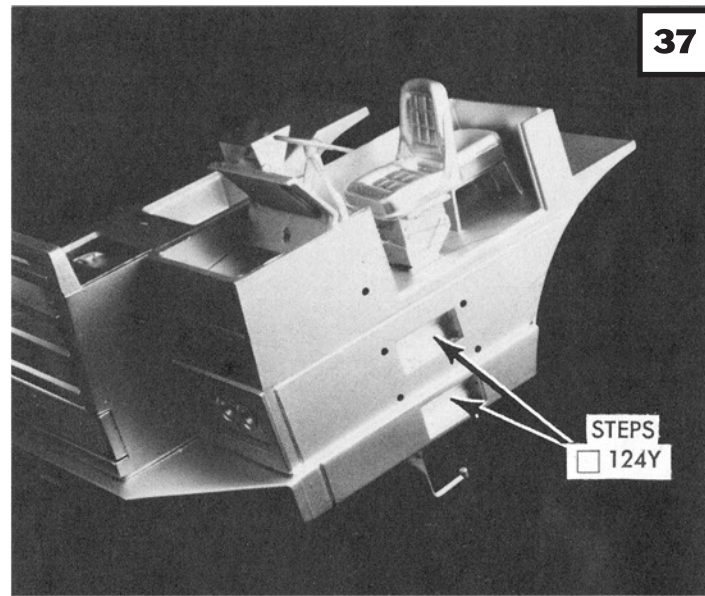
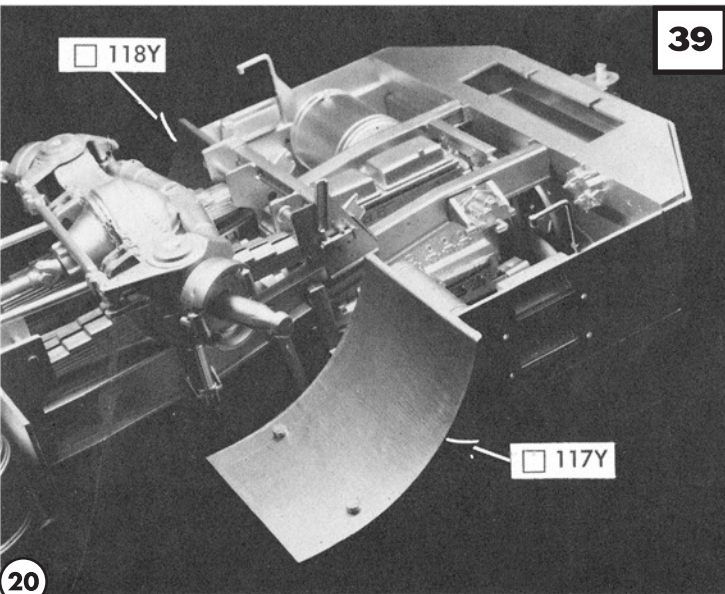

SUB-ASSEMBLIES

RIGHT FUEL TANK

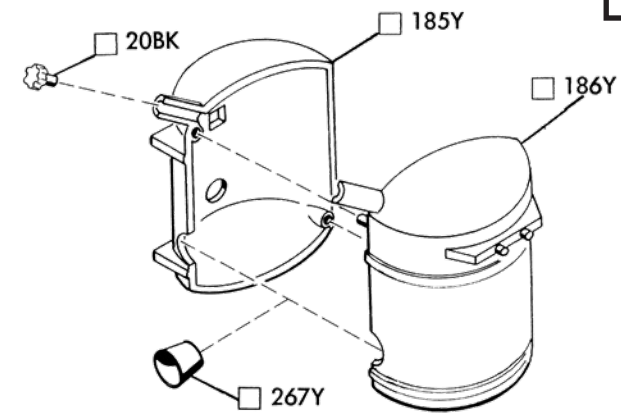

LEFT FUEL TANK

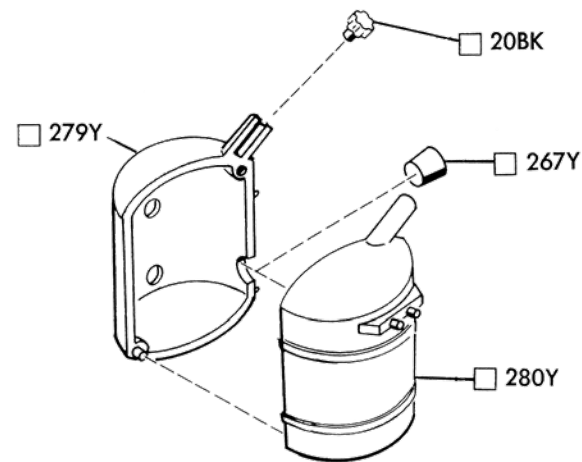

HYDRAULIC TANK

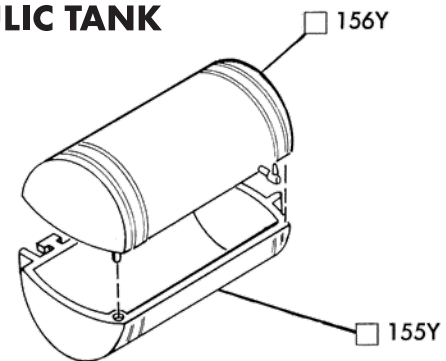

AIR TANKS

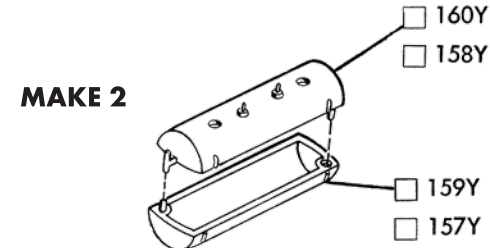

TRANSMISSION

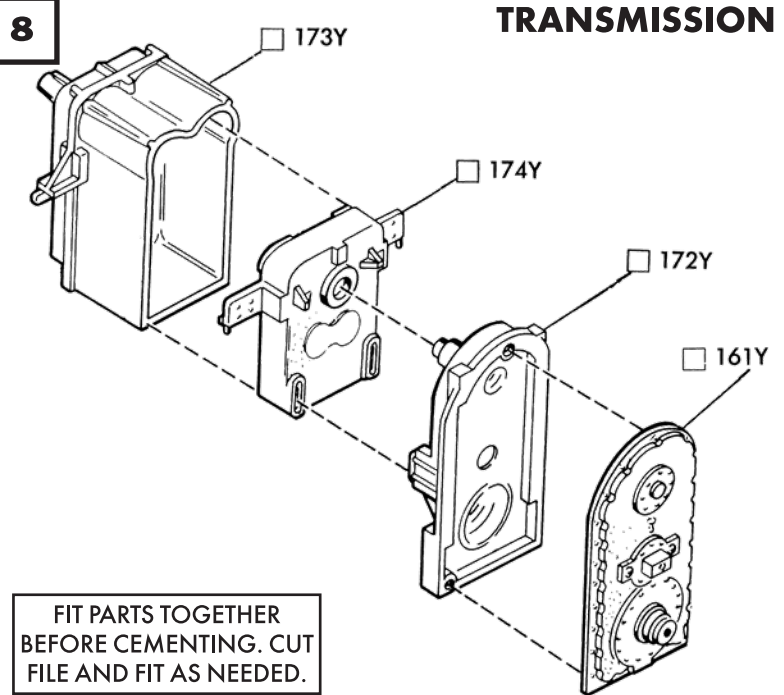

FIT PARTS TOGETHER
BEFORE CEMENTING. CUT
FILE AND FIT AS NEEDED.

BATTERIES

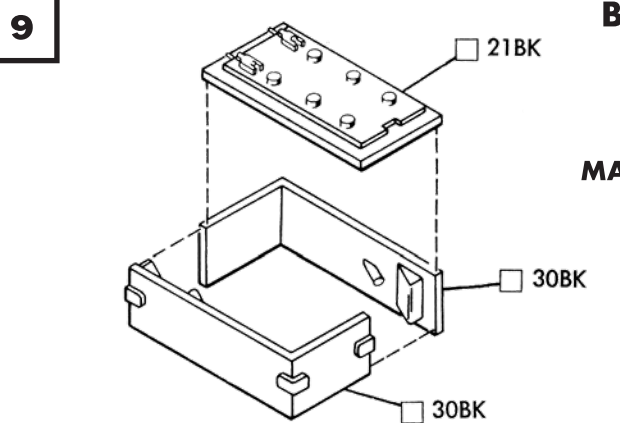

MAKE 2

AIR CLEANERS

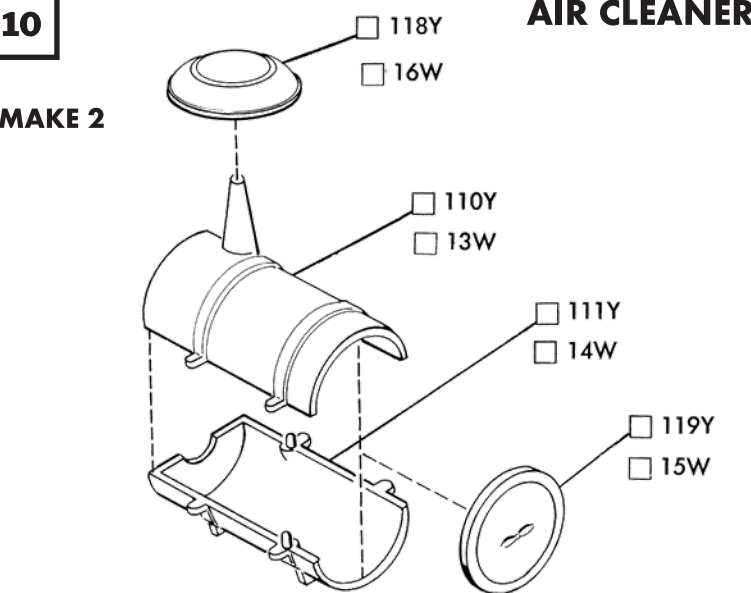

Assemble the air cleaner parts as shown. Complete 2 units: one with yellow parts and one with white parts. Set aside for later.

11 RADIATOR

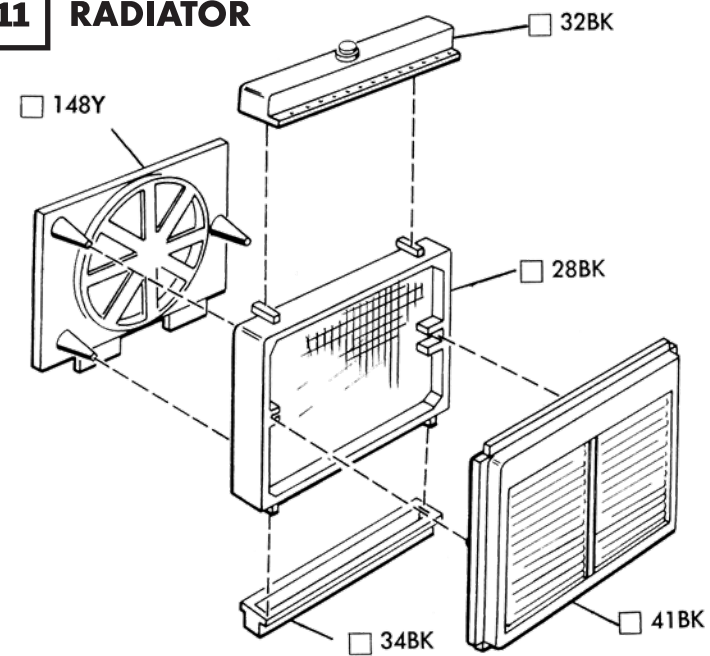

Assemble the radiator, radiator tanks, shutter and shroud as shown. Set aside to dry.

12 CYLINDER UNITS

Paint the inner 3 cylinder units silver for both sets. Assemble one set as shown below. Then assemble a matching set using parts 74 & 75, 68 & 69, 64 & 65, 72 & 73.

**MAKE 2
(One set shown)**

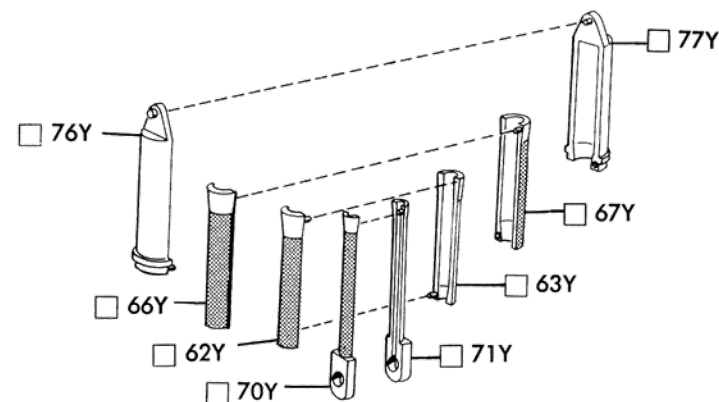

**FIT PARTS TOGETHER
BEFORE CEMENTING. CUT
FILE AND FIT AS NEEDED.**

Trim runners out of basic lower cab unit. The line drawing shows parts used in the next steps. Refer to photos as well.

Glue 33(R) and 33(L) to inside of lower cab. Glue 31 to outside. Glue parts 125 together and to front of bumper. Glue pin—115—through holes in 125. Insert floor unit from bottom as shown below. Slide all the way forward and glue to top of headlight unit and bottom of left upper fender. See last photo on this page.

Glue air cleaner mounts—121—in place as shown. Glue in 2 step boxes—124—and hanging step—139—as shown. Also refer to photos on page 20.

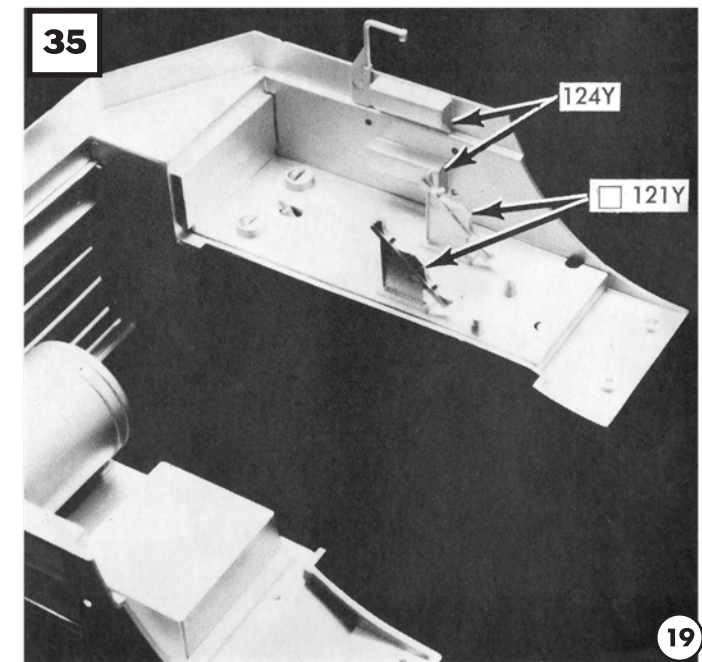
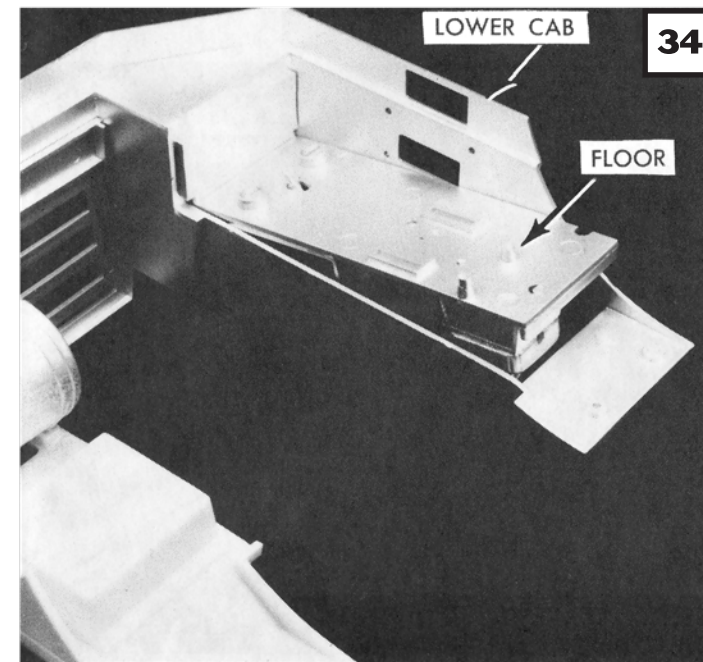
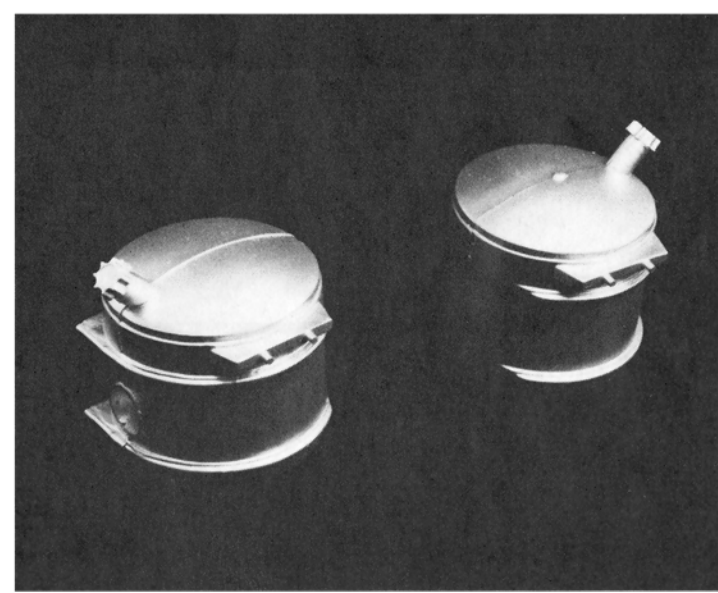
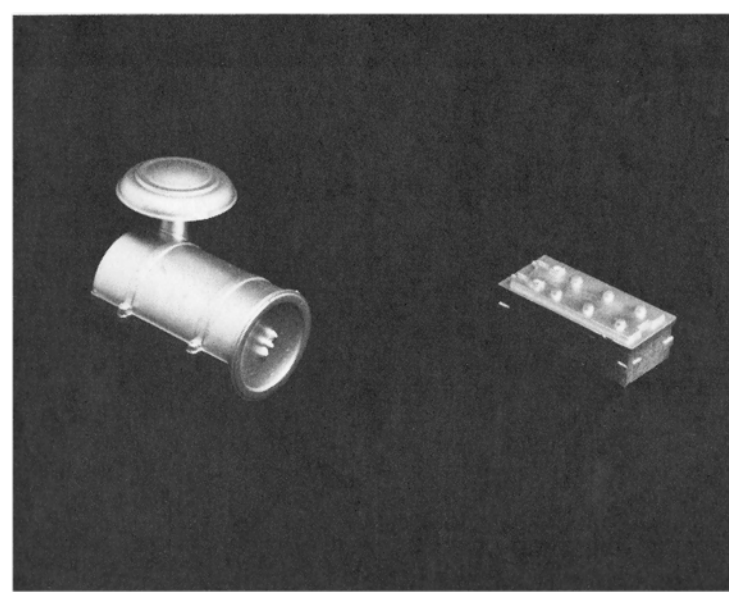
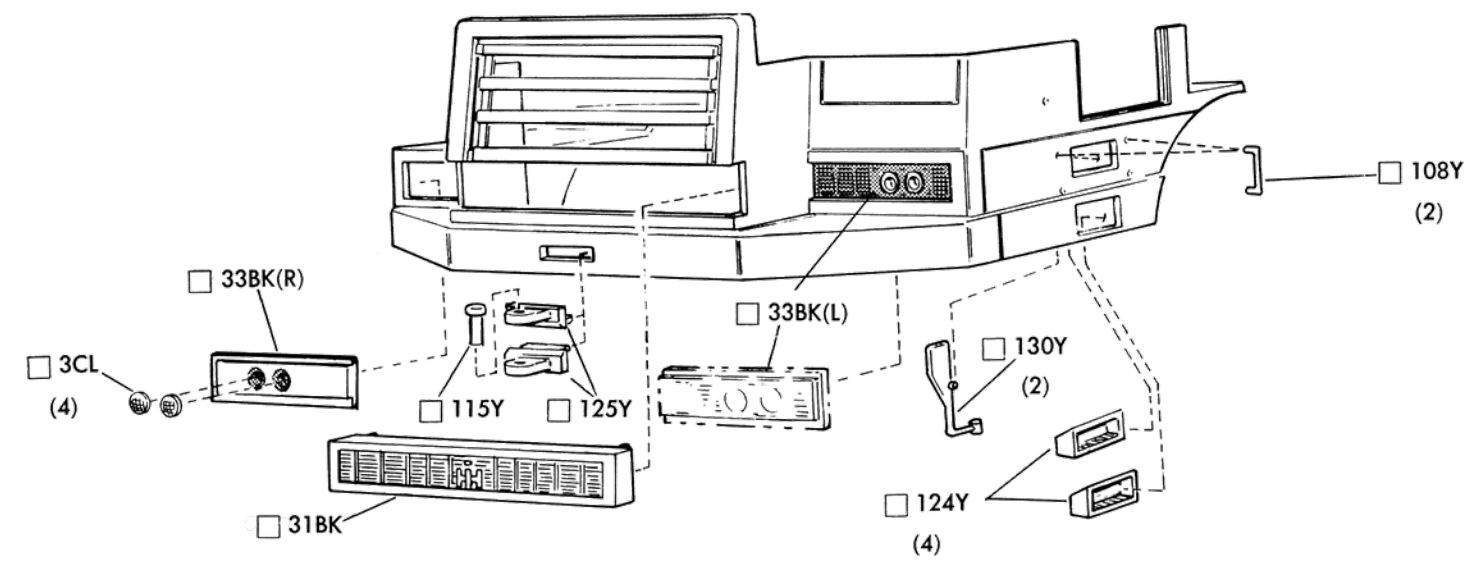
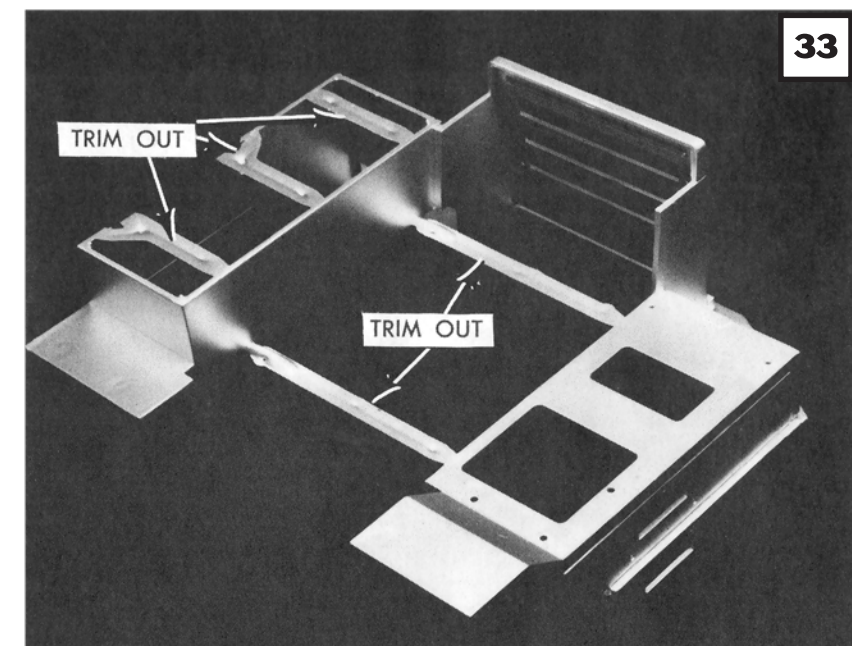

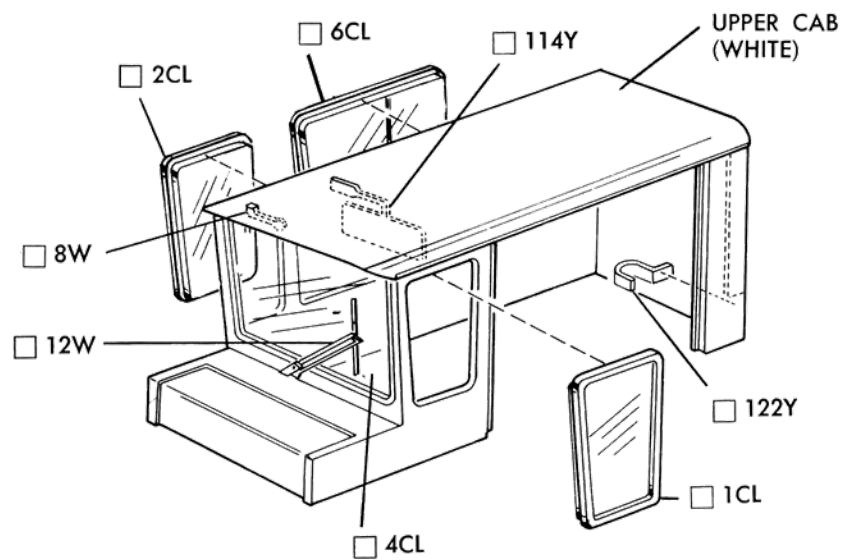

Glue cab interior parts 8, 114 and 122 into place. 114 can be glued in 2 positions—see photo—since it is the visor. The choice is yours. Glue windows into place. Finish by adding windshield wiper.

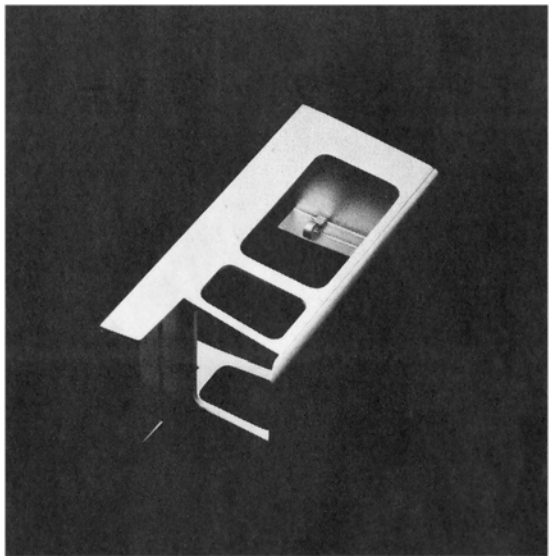
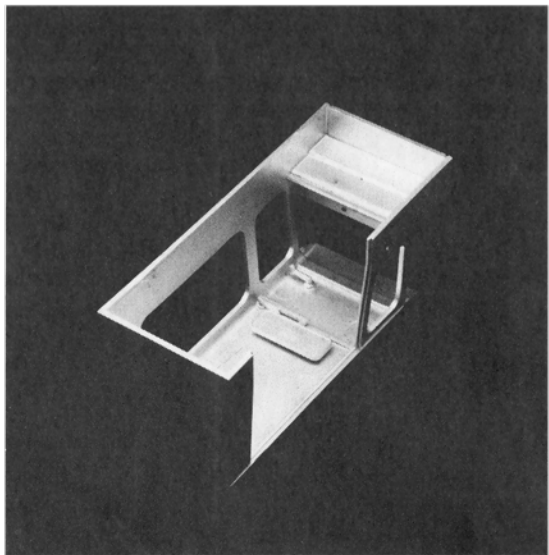

Glue 11, 178 and 131 together as shown—be neat. Glue window into place and add remaining parts. Set aside to dry.

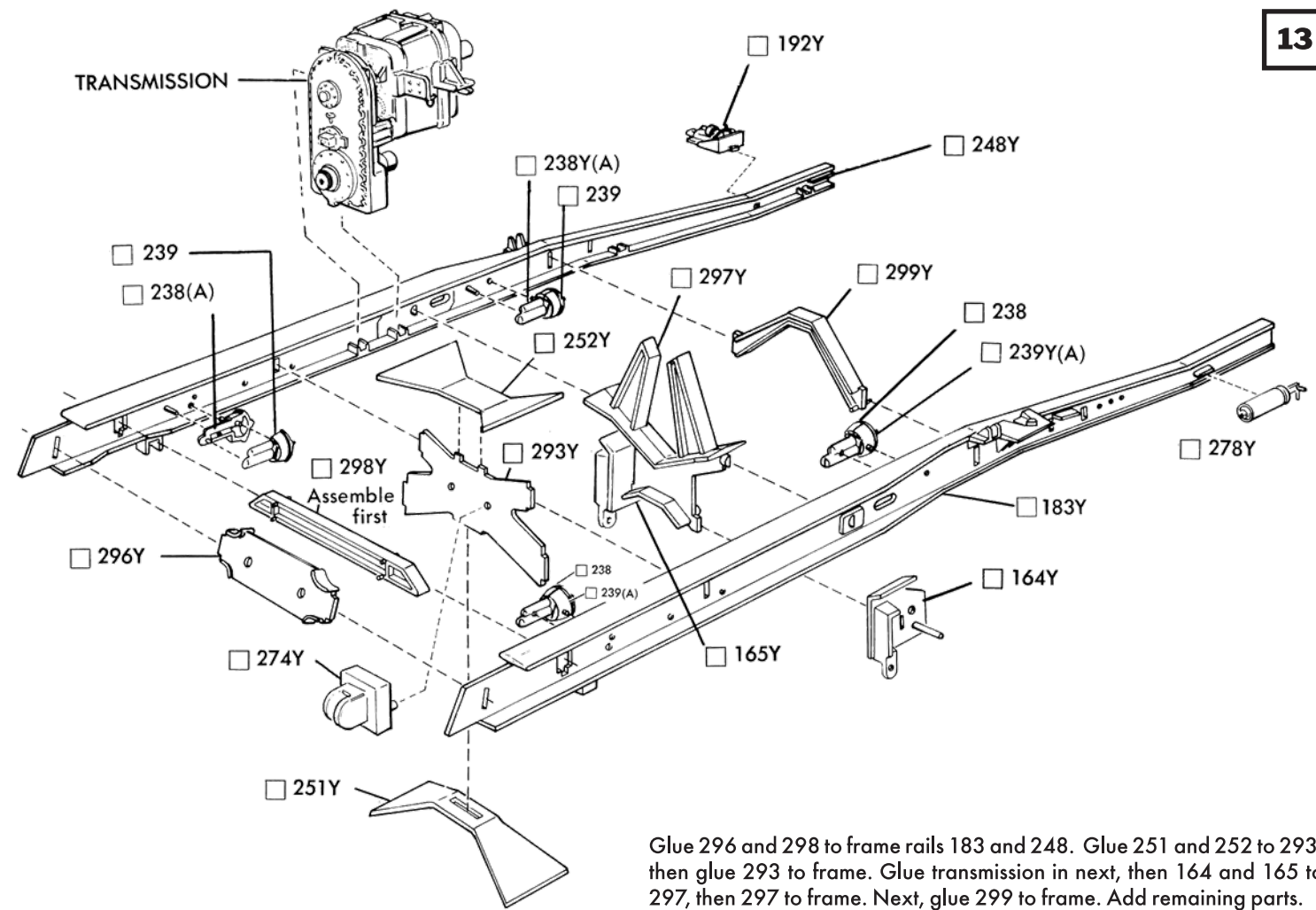
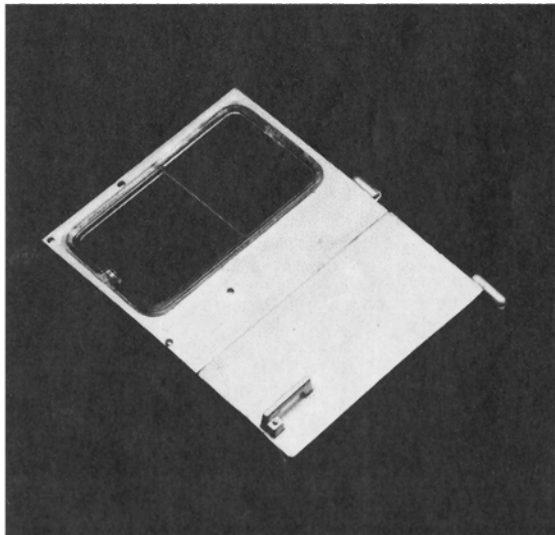
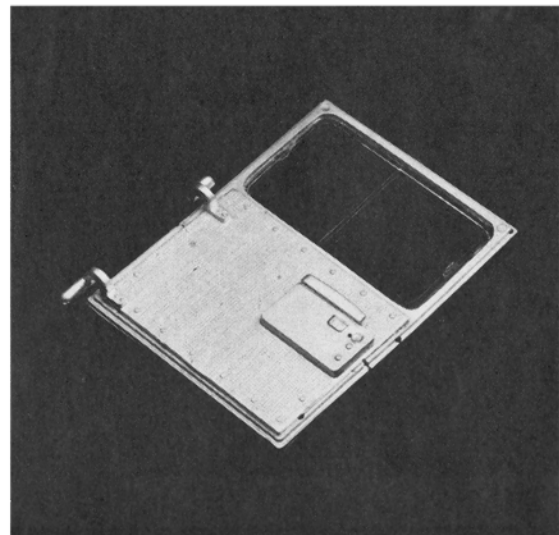
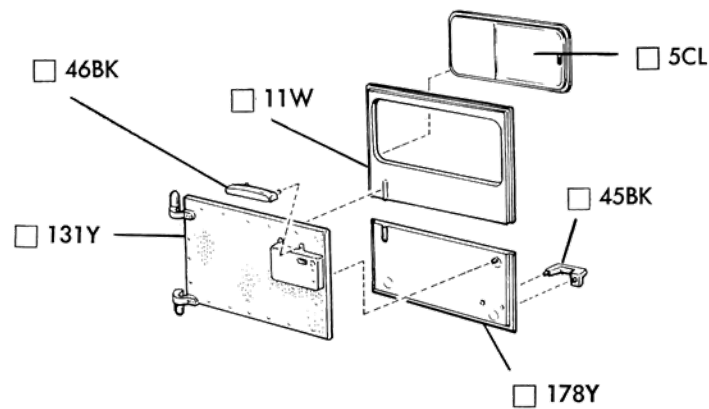

Glue 296 and 298 to frame rails 183 and 248. Glue 251 and 252 to 293, then glue 293 to frame. Glue transmission in next, then 164 and 165 to 297, then 297 to frame. Next, glue 299 to frame. Add remaining parts.

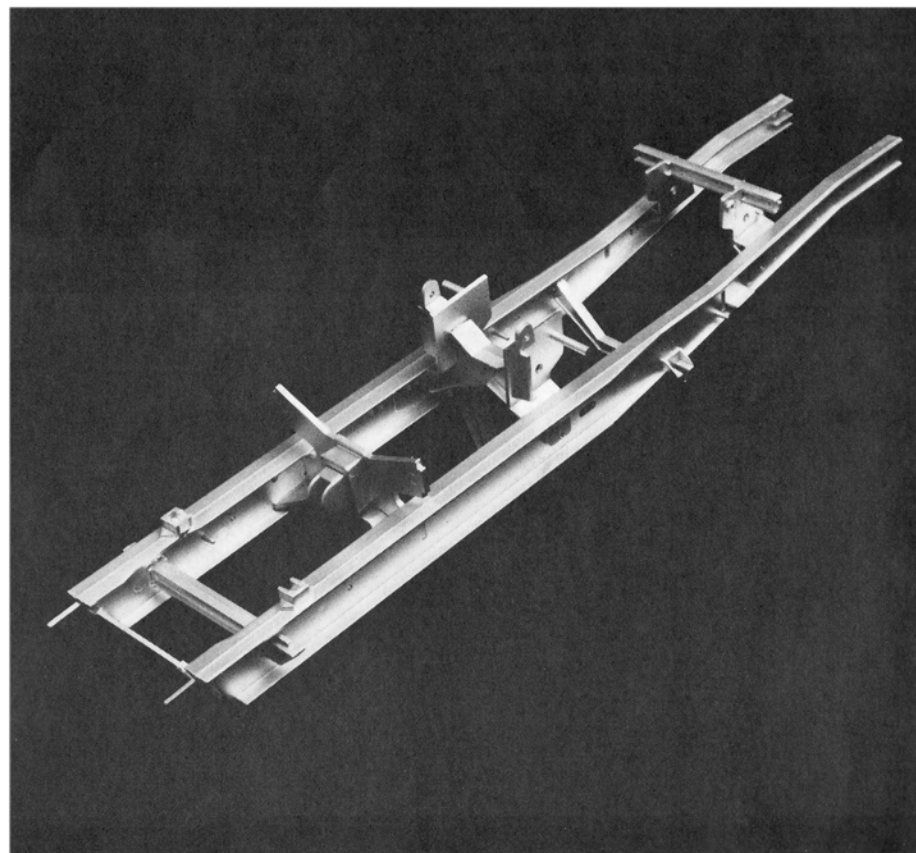

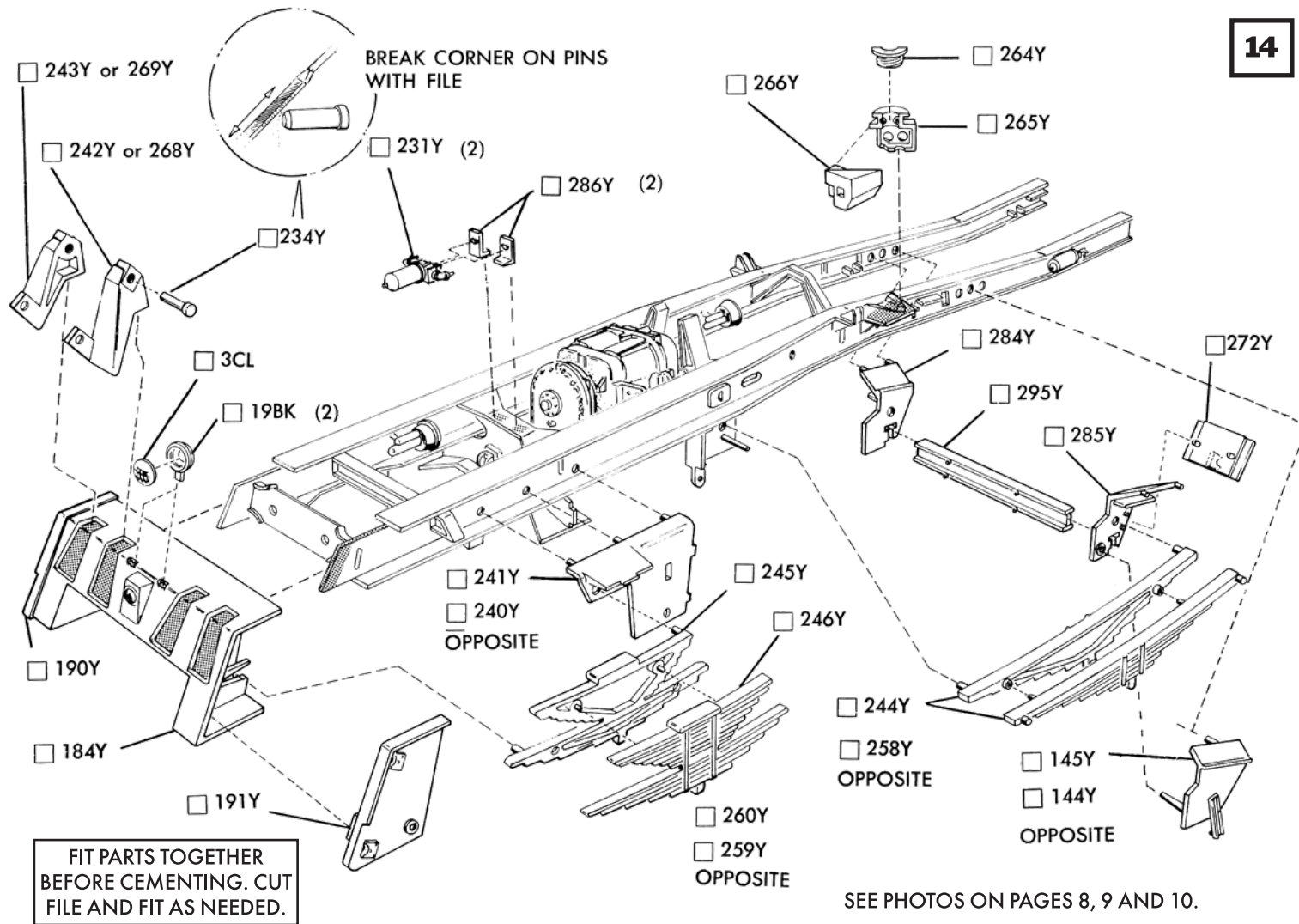

Glue 240 & 241 to the frame. Glue 184 into place. Slip 295 through 284 and 285 up to pins on 295. Glue 284 and 285 to insides of frame rails. Build front and rear spring units and glue in place. Trap springs with 190 & 191 (rear) and 144 & 145 (front). Glue other parts into place.

Assemble the cat interior, beginning with 44 to 23. Next, glue 39 into place then 29. Add 132 and 133. Add remaining parts as shown. The photo below shows finished appearance.

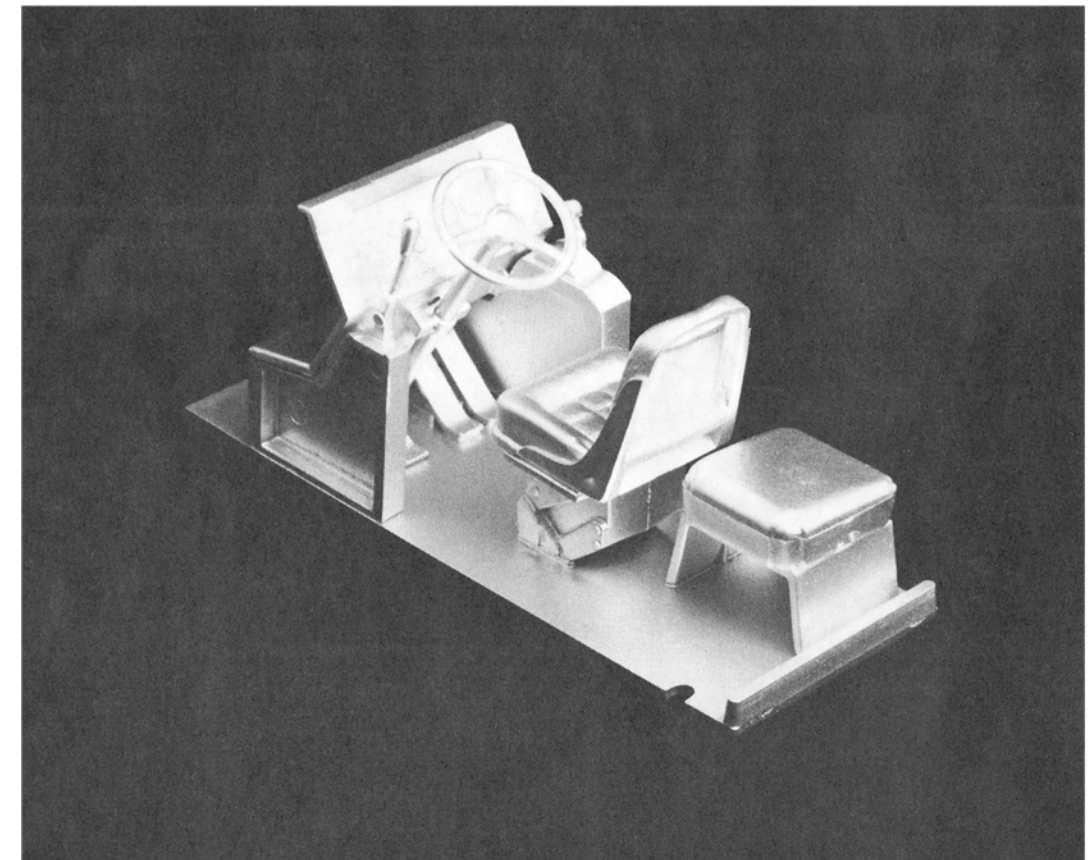
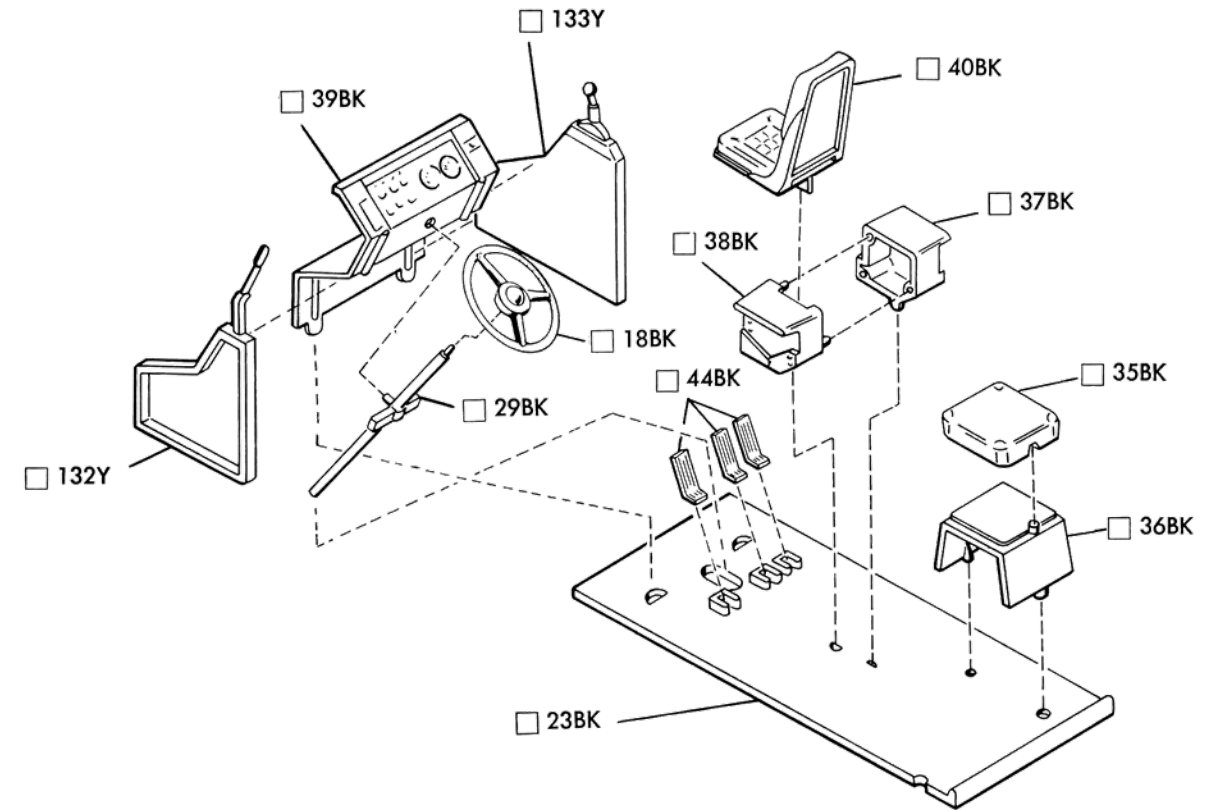

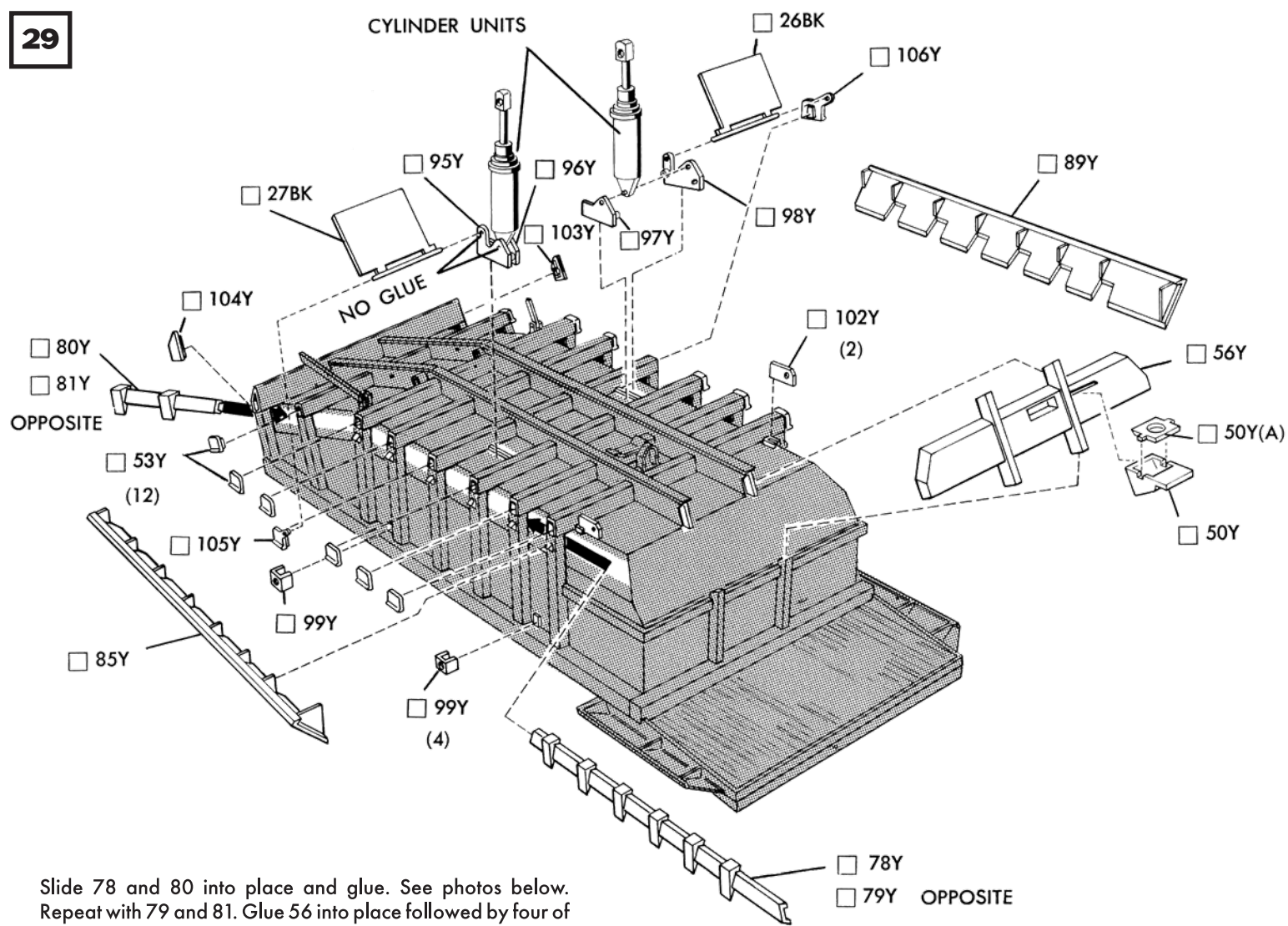

Slide 78 and 80 into place and glue. See photos below. Repeat with 79 and 81. Glue 56 into place followed by four of part 99. Trap a hoist cylinder unit between 95 and 96, gluing 95 and 96 together without getting glue on the cylinder. Glue to dump body. Repeat with 97 and 98. Slide 27 into 95 and glue 105 into place, trapping 27. Assemble remaining parts. Refer to photos below for help.

FIT PARTS TOGETHER BEFORE CEMENTING. CUT FILE AND FIT AS NEEDED.

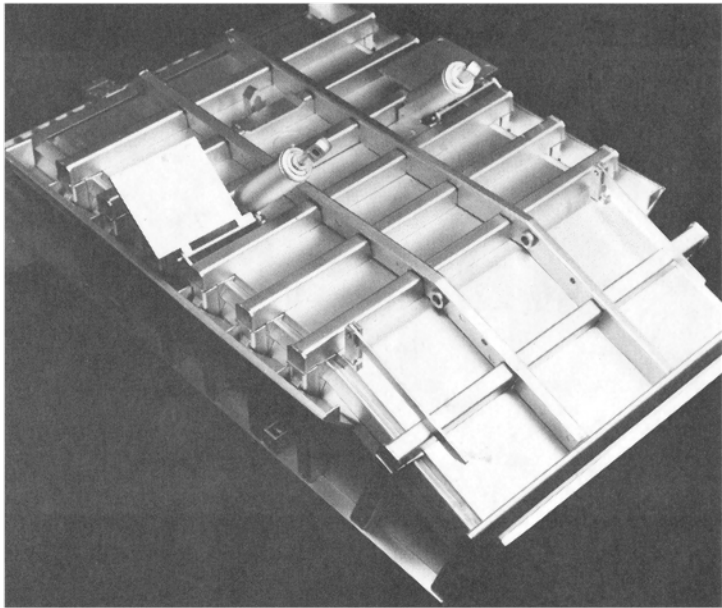
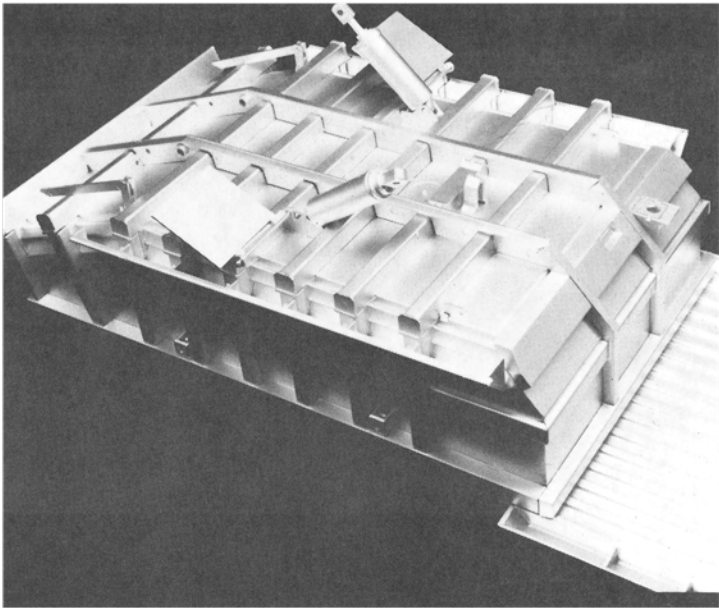

Assemble main hoist boxes as shown by gluing walls 249 and 250 into place. Glue 282 and 187 into place. Glue four 277 pieces into place. Glue 162 and 163 into place. Add the remaining parts. Note: 255 is retained by pin 233—DO NOT PUT GLUE ON RADIUS RODS 255 & 256.

SEE PHOTOS BELOW.

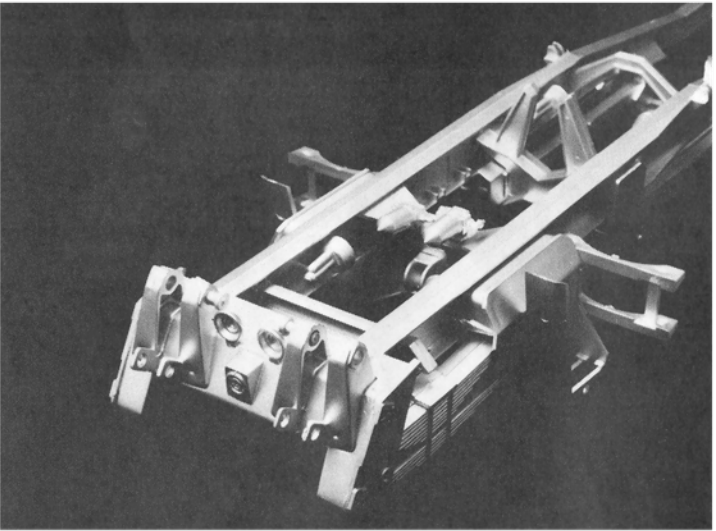
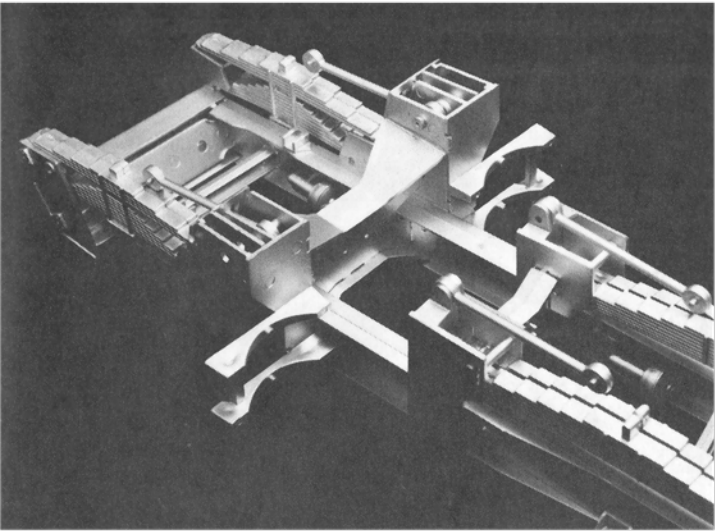
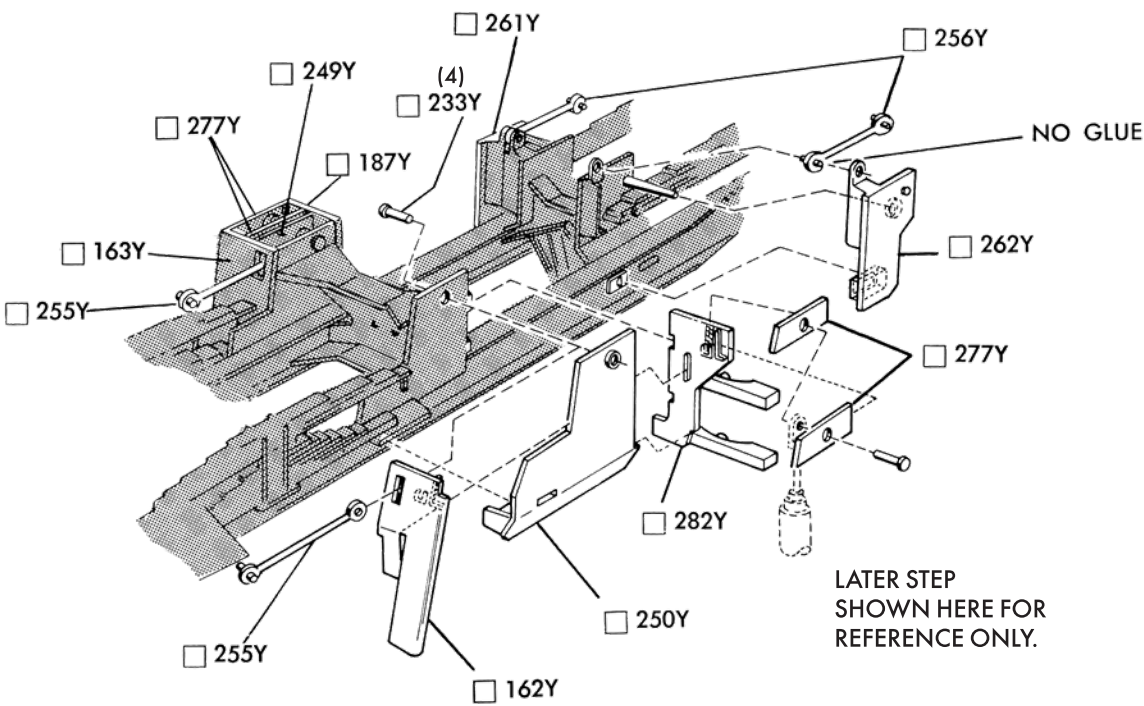

FRAME DETAIL PHOTOS

The photographs below show various frame parts in their finished relationship. The gap between the front springs is intentional—the actual vehicle has 4 front springs too! Please work carefully—trimming and fitting parts as you go. Your AMT kit is near-perfection but still requires the touch of a good modeler to turn it into a great kit. Take your time and allow glue to dry.

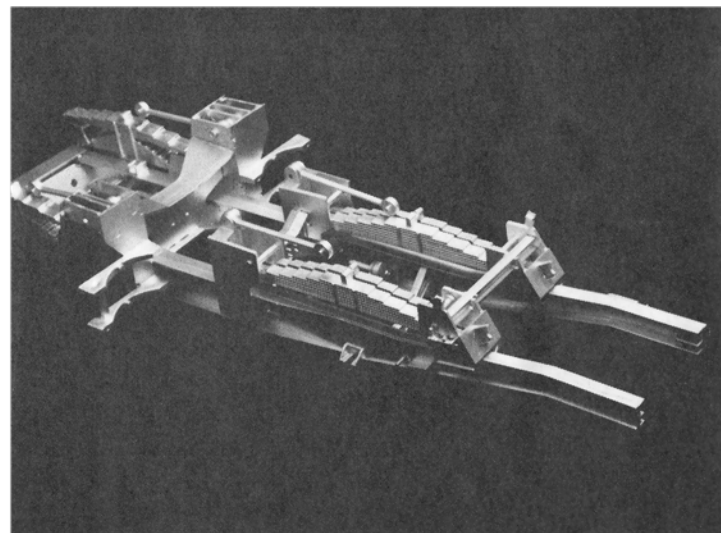
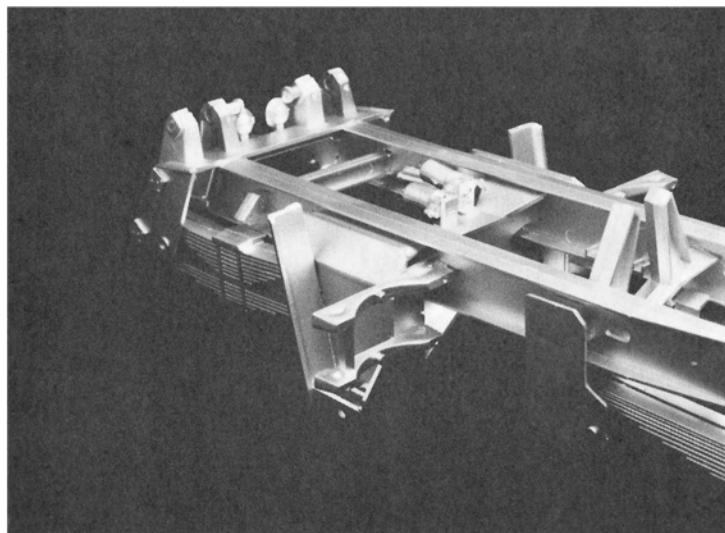
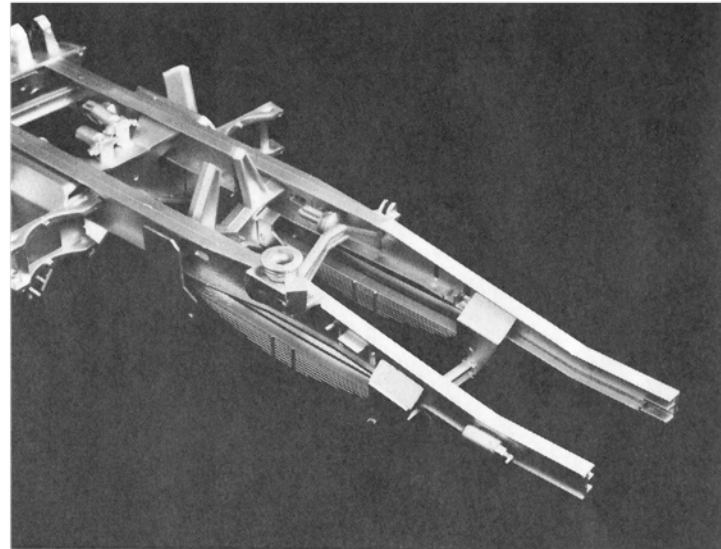
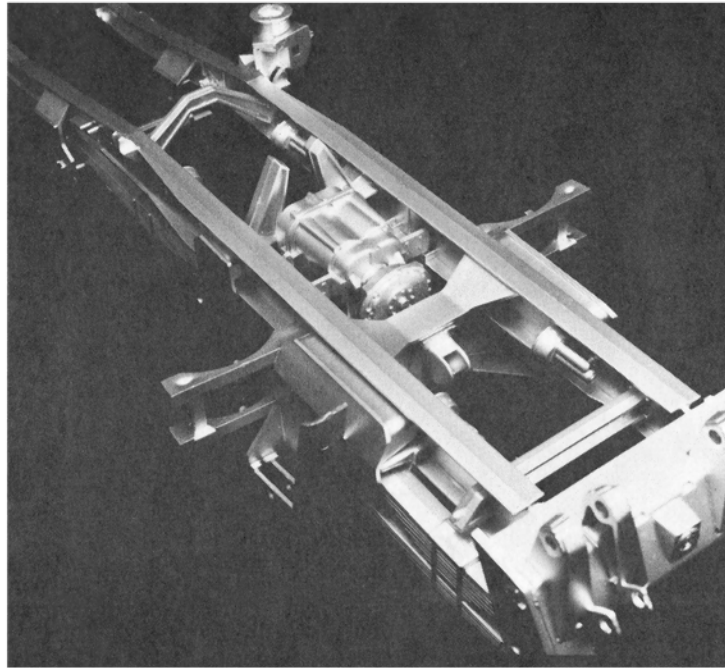

27

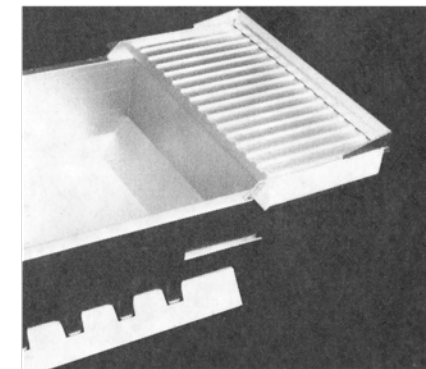
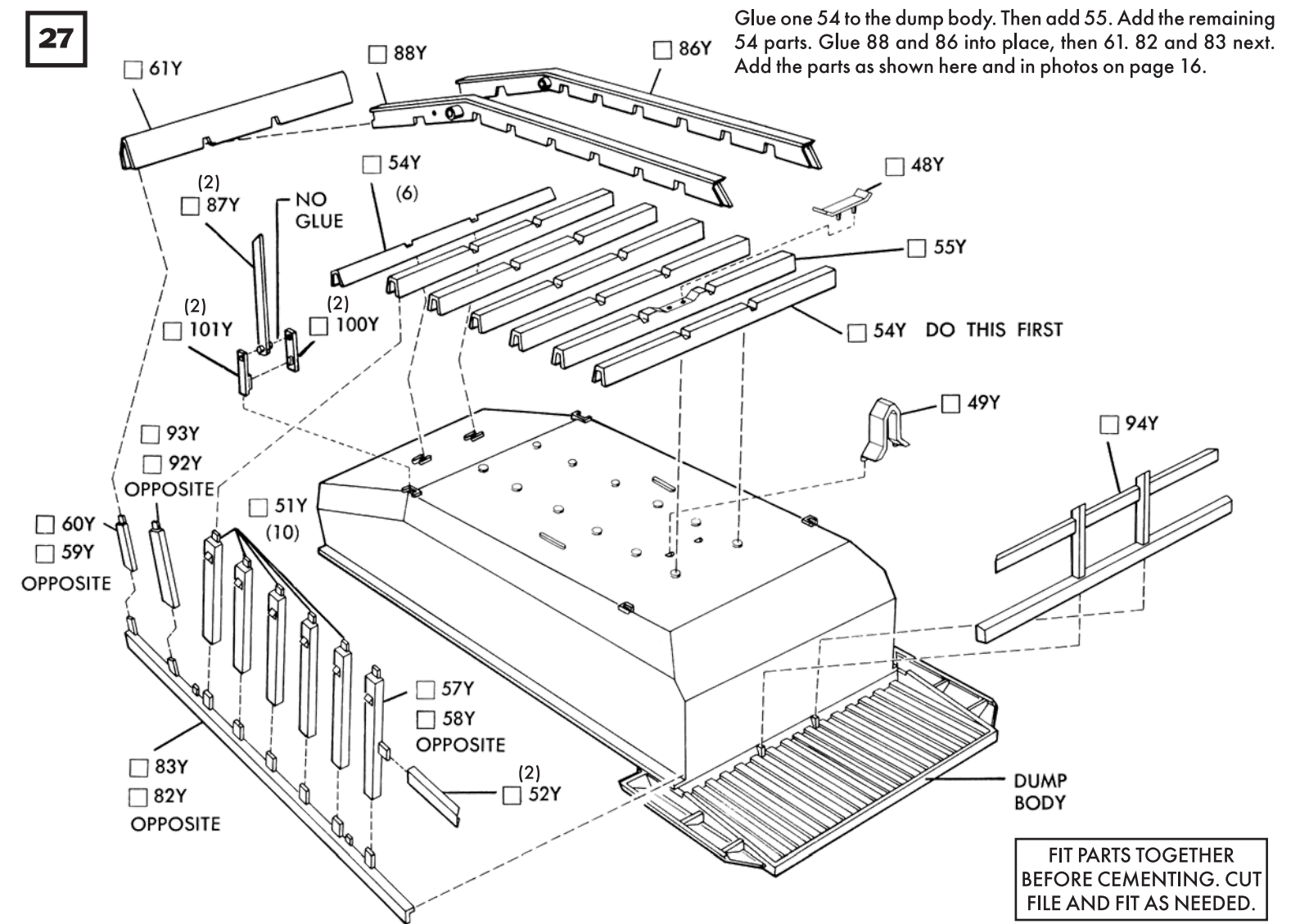

Glue guard parts into place as shown. Slight file touch-ups will make parts fit better. Add decal as shown below and on page 1.

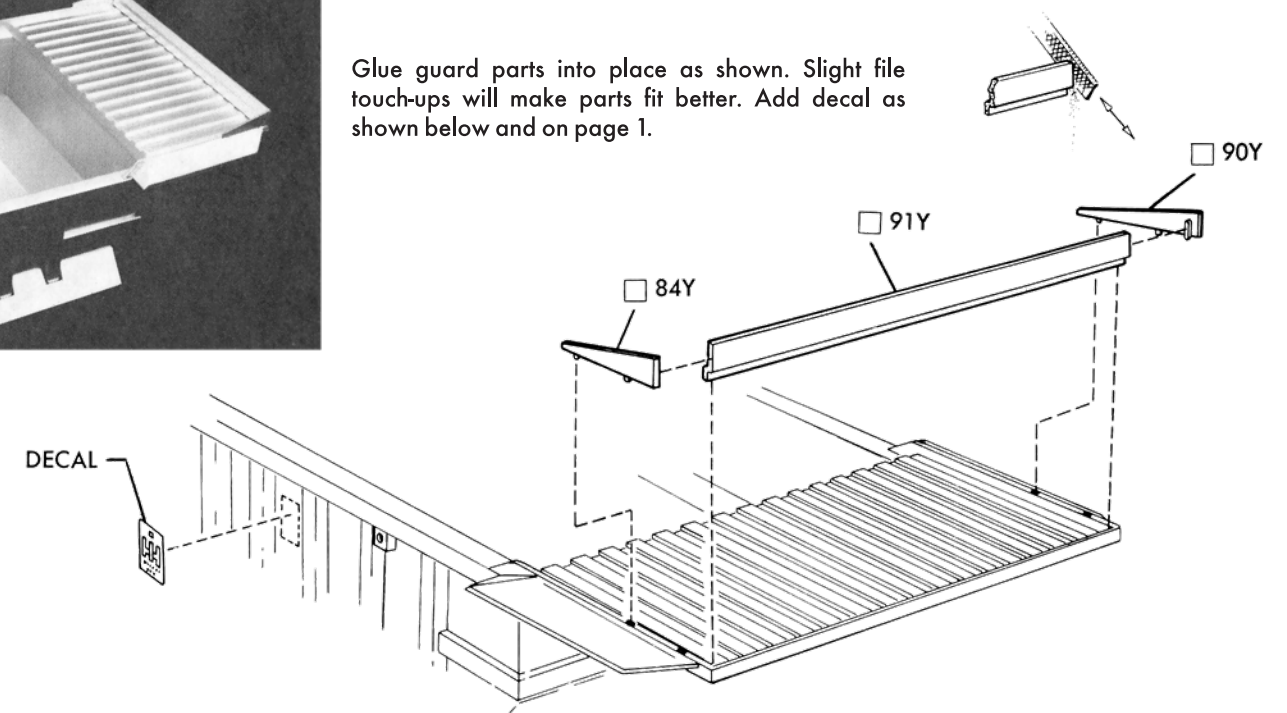

28

Glue 203 to 152 and then glue unit to frame. Glue support brackets 294 and 253 to each side of the frame. Glue radiator to 203 and to center of fan. Add hoses—128. Glue 273 to 203—see photo below.

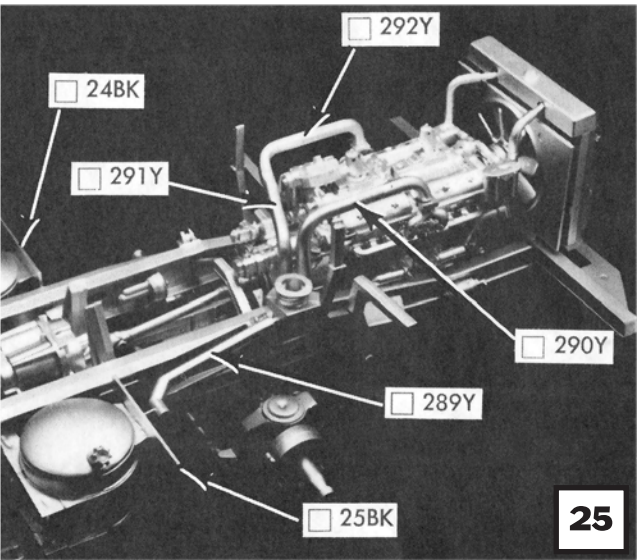
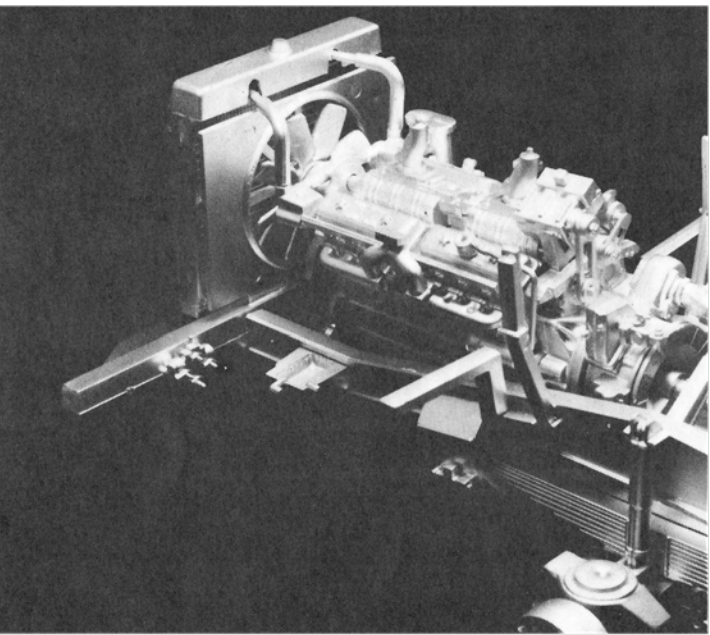
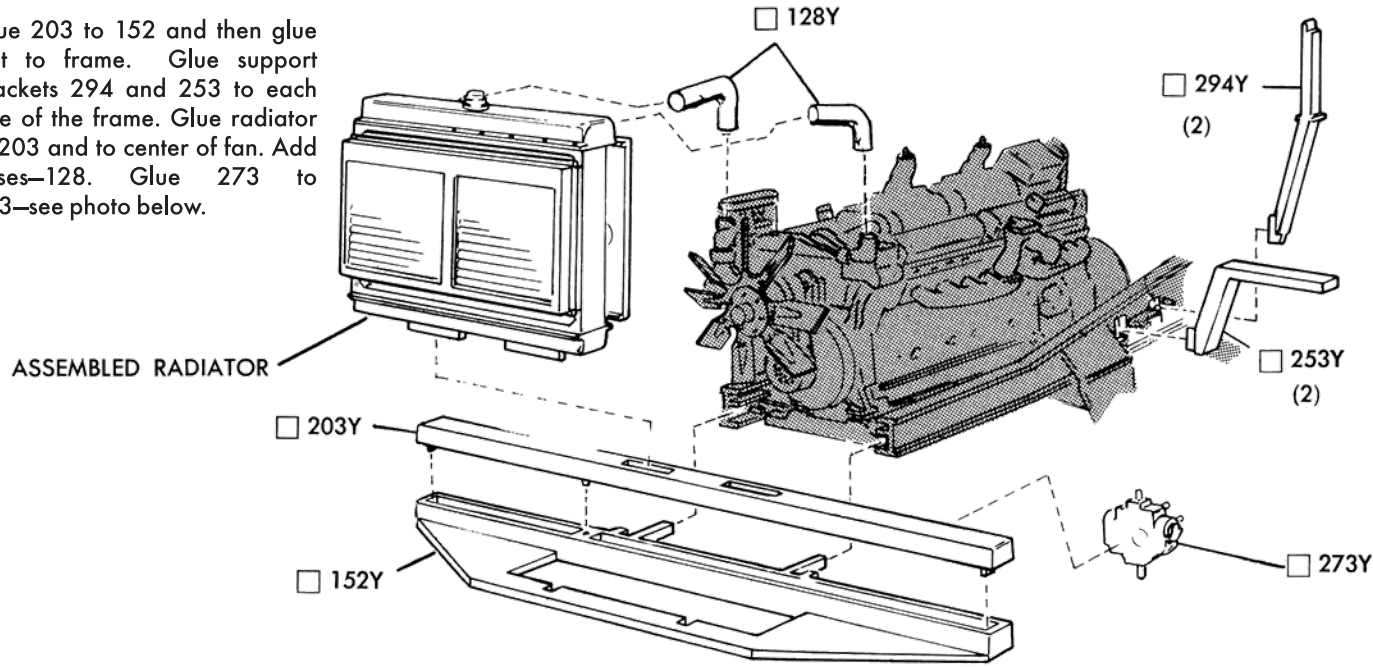

Glue mud flaps 24 & 25 into place. Glue exhaust pipe 289 into valve box and center hole of mud flap. Glue pipe 290 into place as shown. Glue pipes 291 and 292 together, and to manifold and hole in valve box...hold in position until glue sets.

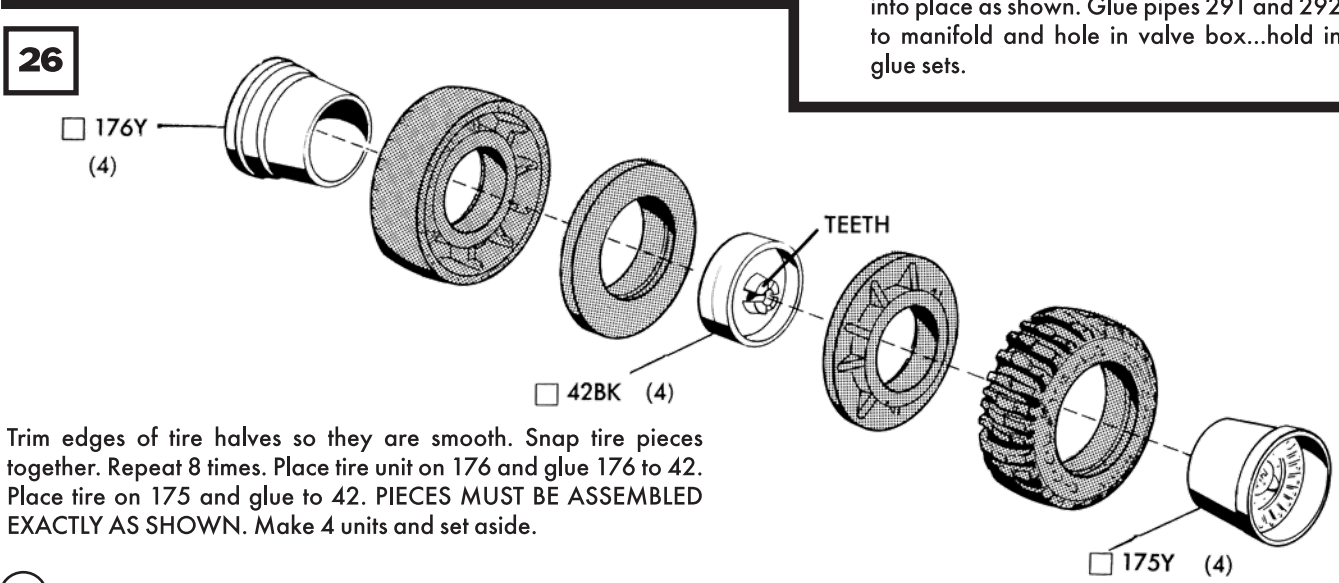

Trim edges of tire halves so they are smooth. Snap tire pieces together. Repeat 8 times. Place tire unit on 176 and glue 176 to 42. Place tire on 175 and glue to 42. PIECES MUST BE ASSEMBLED EXACTLY AS SHOWN. Make 4 units and set aside.

REAR AXLE

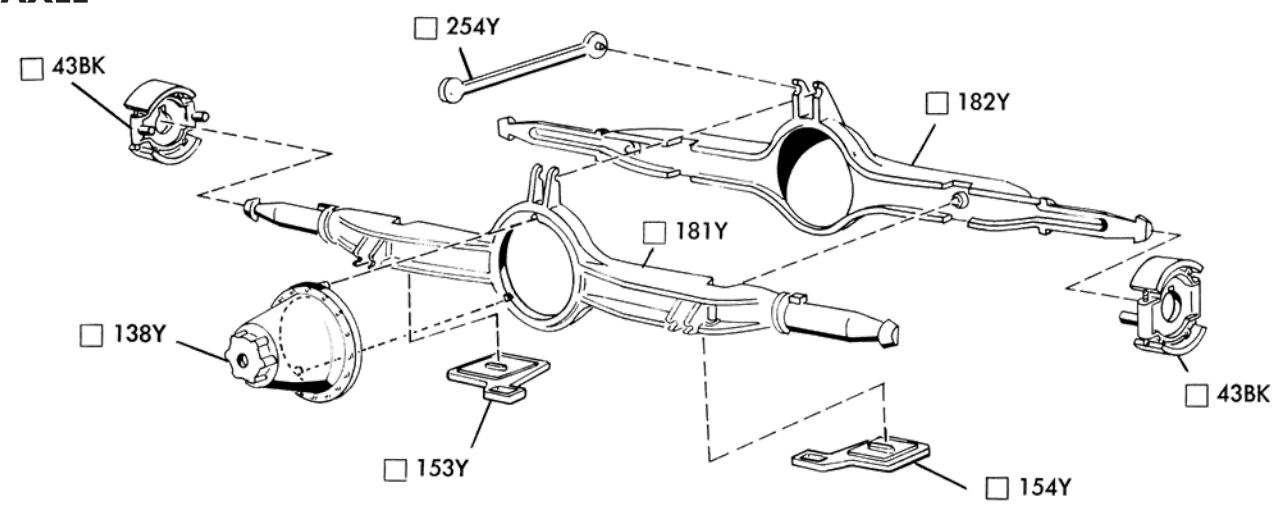

Glue the front (181) and rear (182) axle halves together, trapping radius rod 254Y in place as shown. DO NOT GLUE 254. Add the remaining parts as shown.

FIT PARTS TOGETHER BEFORE CEMENTING. CUT FILE AND FIT AS NEEDED.

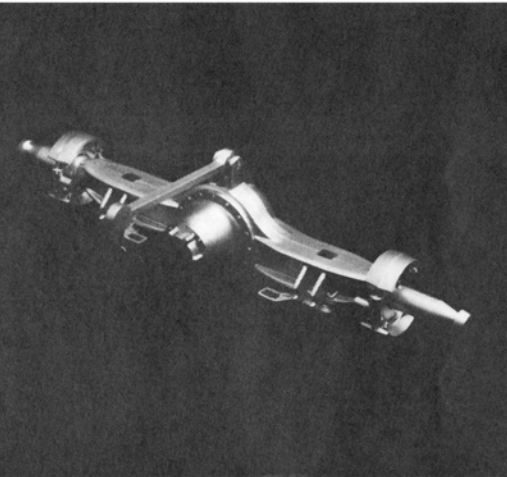

FRONT AXLE

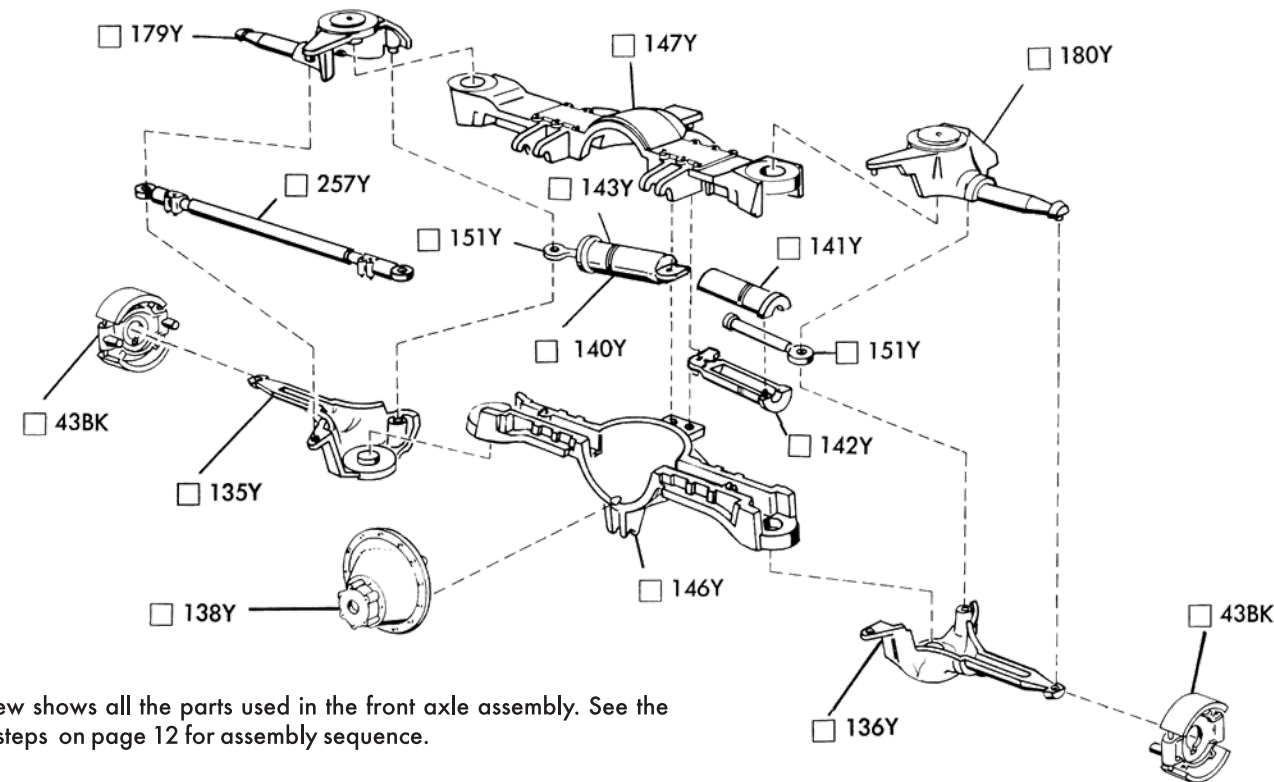

This view shows all the parts used in the front axle assembly. See the photo steps on page 12 for assembly sequence.

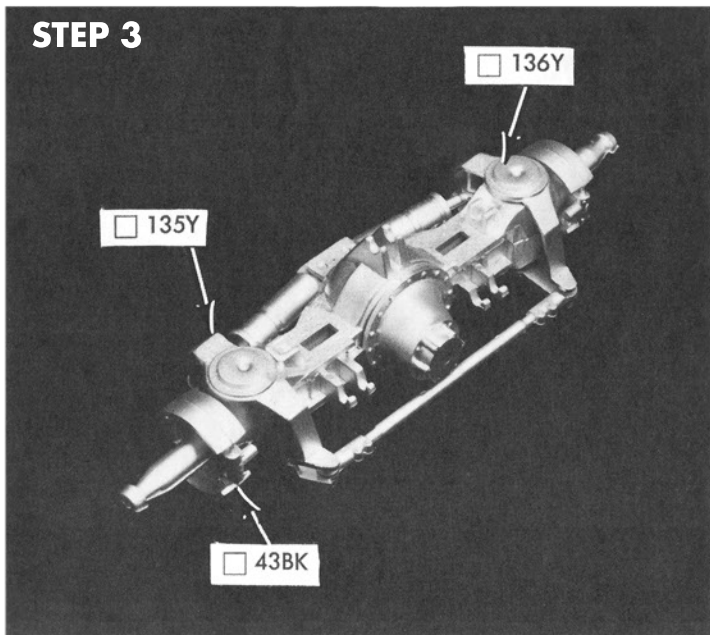
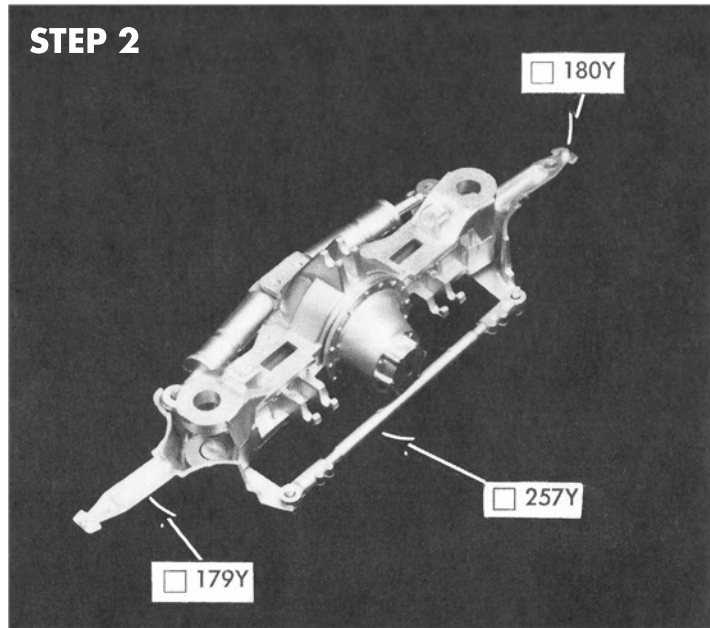
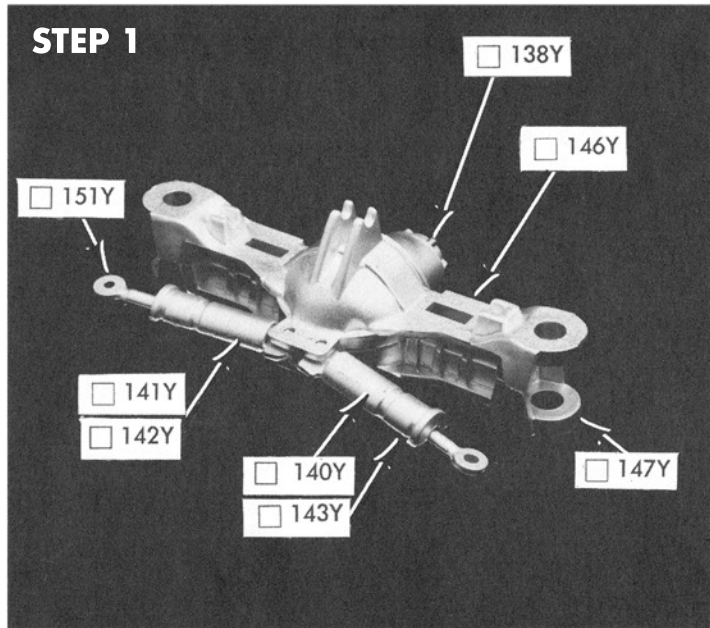

FRONT AXLE

Glue the steering cylinder components 140, 143; 141, 142; 151 together. Be sure 151 slides back and forth. Now trap the cylinders between 146 & 147 as they are glued together. Add 138. Lay the axle assembly on 179 and 180. Lay 257 into place—DO NOT GLUE. Glue 135 to 179, trapping 257. Glue 136 to 180, trapping the other end of 257.

FIT PARTS TOGETHER BEFORE CEMENTING. CUT FILE AND FIT AS NEEDED.

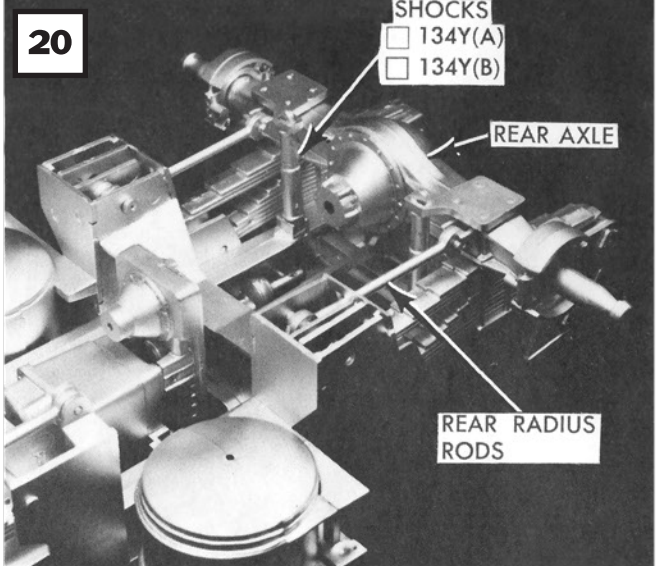
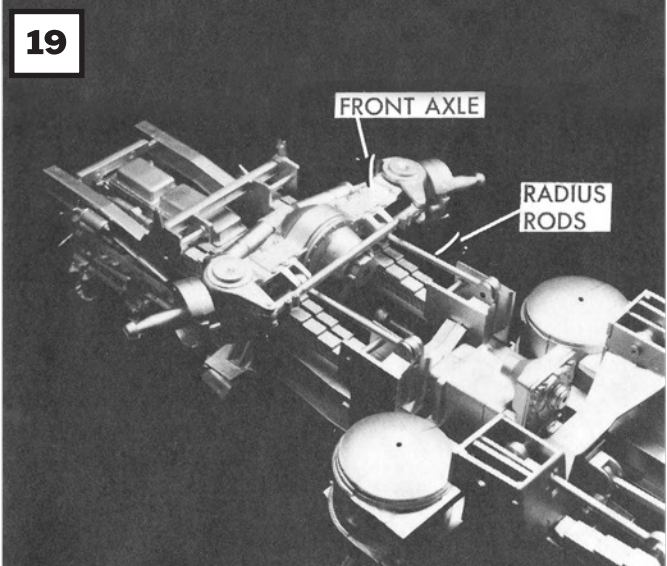

NOTE POSITION OF RADIUS RODS

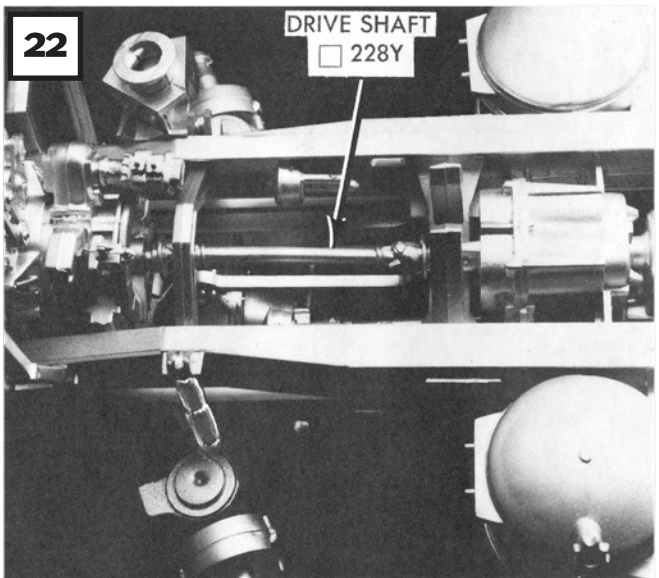
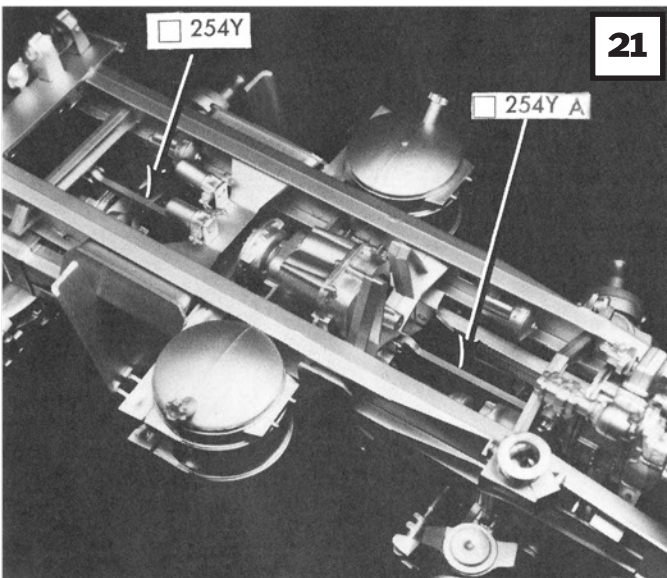

Glue the engine into place on the frame locators. Glue shock absorber halves together—make 4 sets. Glue front axle into place and add shocks.

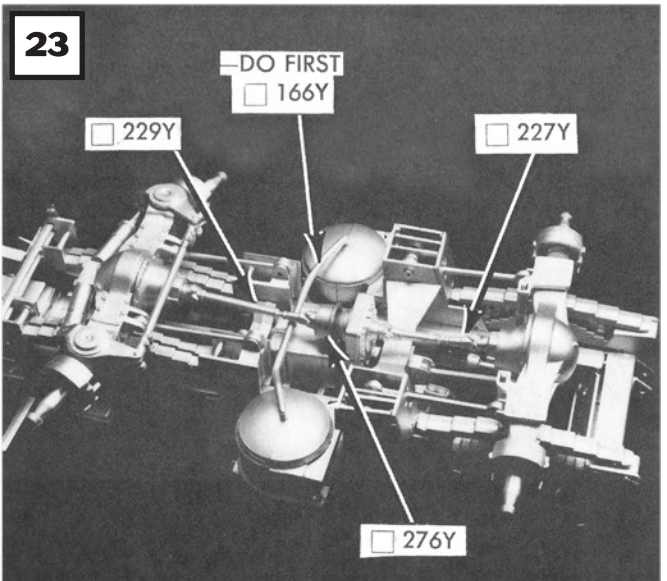
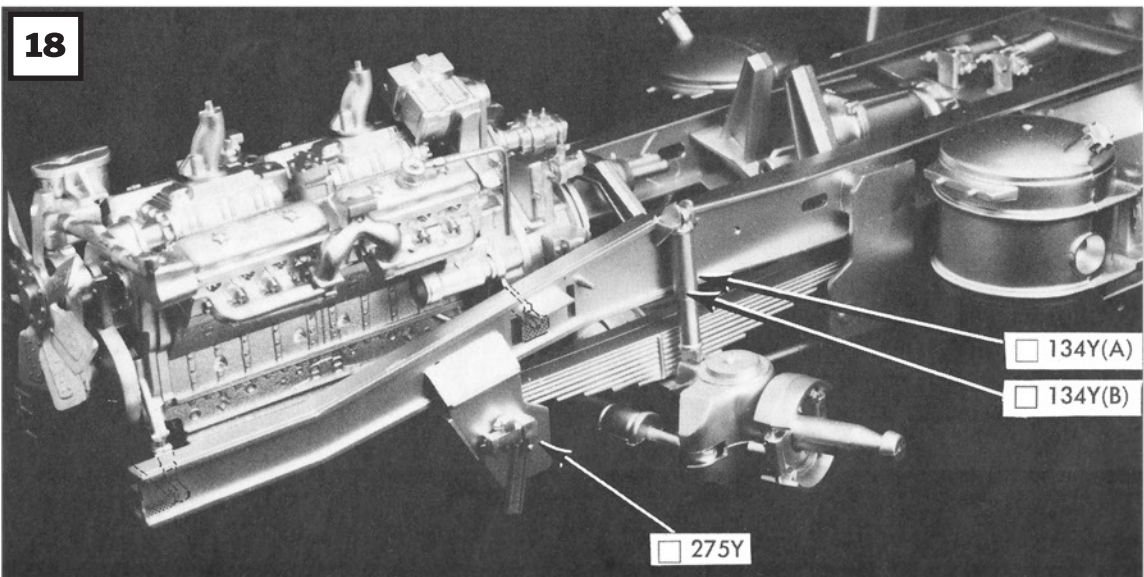

AXLES—RADIUS RODS—DRIVE DRAFTS—SHOCKS

Study the photo sequence carefully, gluing the axles into place and guiding the radius arms into proper position. Use tweezers in these steps.

FIT PARTS TOGETHER BEFORE CEMENTING. CUT FILE AND FIT AS NEEDED.